



## **Pulegge dentate HTD® monoblocco**

Monobloc HTD® timing pulleys  
Monoblock HTD® Zahnriemenscheiben  
Poulies dentées HTD® moyeu plein  
Poleas dentadas HTD® macizas





## Pulegge dentate HTD® monoblocco

Monobloc HTD® timing pulleys  
Monoblock HTD® Zahnriemenscheiben  
Poulies dentées HTD® moyeu plein  
Poleas dentadas HTD® macizas

### Forme costruttive

Design features - Konstruktionsmerkmale - Caractéristiques - Características

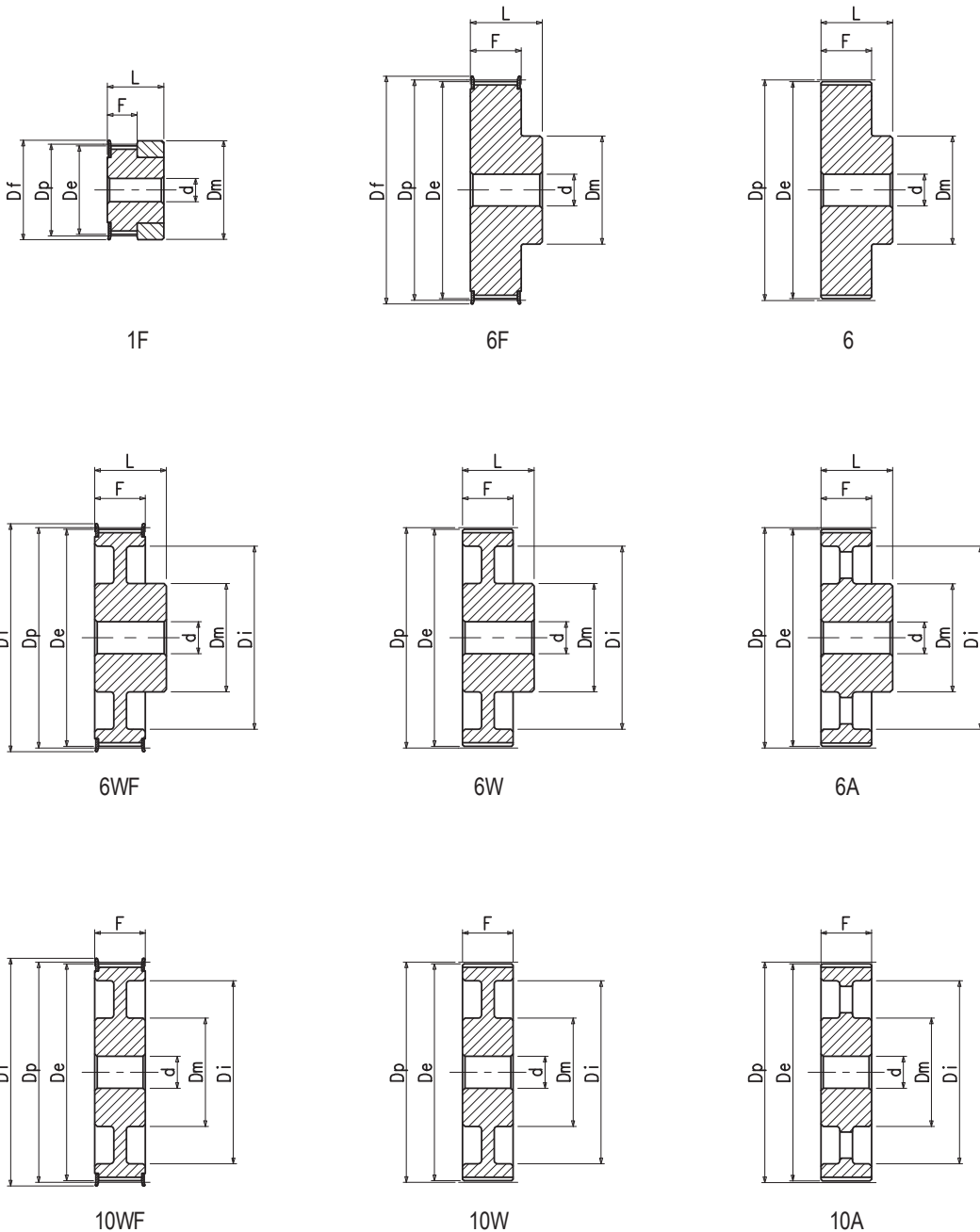



## Pulegge dentate HTD® monoblocco

Monobloc HTD® timing pulleys  
 Monoblock HTD® Zahnriemenscheiben  
 Poulies dentées HTD® moyeu plein  
 Poleas dentadas HTD® macizas

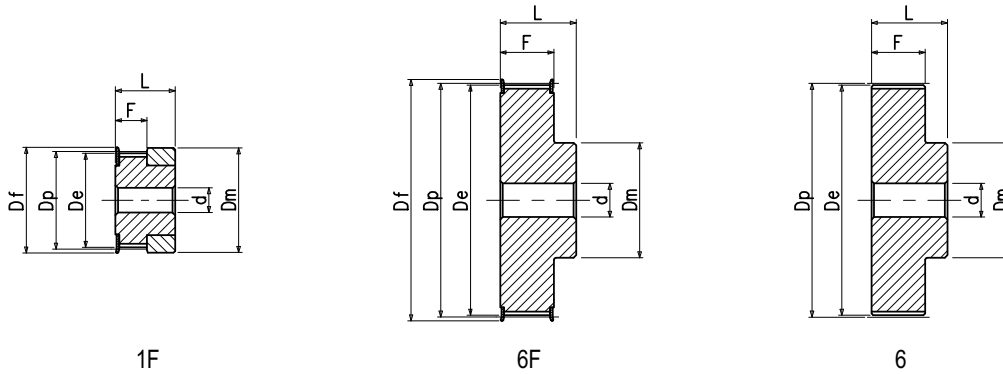

### HTD® 3M 06 Passo - Pitch - Teilung - Pas - Paso 3 mm

| Materiale<br>Material<br>Werkstoff<br>Matériel<br>Material  | Codice<br>Item number<br>Codierung<br>Code<br>Código | Descrizione<br>Designation<br>Bezeichnung<br>Désignation<br>Referencia | N° denti<br>No. of teeth<br>Anzahl der<br>Zähne<br>Nombre de<br>dents<br>Cantidad de<br>dientes | Dp    | De    | Df   | Dm   | F    | L    | d  | Peso<br>Weight<br>Gewicht<br>Poids<br>Peso<br>kg |
|---|--|--|---|-------|-------|------|------|------|------|----|--|
|   |  |  |   | mm    | mm    | mm   | mm   | mm   | mm   | mm |  |
| Aluminio<br>Aluminium<br>Aluminium<br>Aluminium<br>Aluminio | 32D010006  | 10 3M 6 - 1F *   | 10  | 9,55  | 8,79  | 13,0 | 13,0 | 8,5  | 14,5 | -  |  |
|   | 32D012006  | 12 3M 6 - 1F *   | 12  | 11,46 | 10,70 | 15,0 | 15,0 | 8,5  | 14,5 | -  |  |
|   | 32D014006  | 14 3M 6 - 1F *   | 14  | 13,37 | 12,61 | 16,0 | 16,0 | 8,5  | 14,5 | -  |  |
|   | 32D015006  | 15 3M 6 - 1F *   | 15  | 14,32 | 13,56 | 17,5 | 17,5 | 8,5  | 14,5 | -  |  |
|   | 32D016006  | 16 3M 6 - 6F *   | 16  | 15,28 | 14,52 | 18,0 | 10,0 | 9,8  | 17,5 | 4  |  |
|   | 32D018006  | 18 3M 6 - 6F *   | 18  | 17,19 | 16,43 | 19,5 | 11,0 | 9,8  | 17,5 | 6  |  |
|   | 32D020006  | 20 3M 6 - 6F *   | 20  | 19,10 | 18,34 | 23,0 | 13,0 | 9,8  | 17,5 | 6  |  |
|   | 32D021006  | 21 3M 6 - 6F *   | 21  | 20,05 | 19,29 | 25,0 | 14,0 | 9,8  | 17,5 | 6  |  |
|   | 32D022006  | 22 3M 6 - 6F *   | 22  | 21,01 | 20,25 | 25,0 | 14,0 | 9,8  | 17,5 | 6  |  |
|   | 32D024006  | 24 3M 6 - 6F *   | 24  | 22,92 | 22,16 | 25,0 | 14,0 | 9,8  | 17,5 | 6  |  |
|   | 32D026006  | 26 3M 6 - 6F *   | 26  | 24,83 | 24,07 | 28,0 | 16,0 | 9,8  | 17,5 | 6  |  |
|   | 32D028006  | 28 3M 6 - 6F *   | 28  | 26,74 | 25,98 | 32,0 | 18,0 | 9,8  | 17,5 | 6  |  |
|   | 32D030006  | 30 3M 6 - 6F *   | 30  | 28,65 | 27,89 | 32,0 | 20,0 | 9,8  | 17,5 | 6  |  |
|   | 32D032006  | 32 3M 6 - 6F *   | 32  | 30,56 | 29,80 | 36,0 | 22,0 | 9,8  | 17,5 | 6  |  |
|   | 32D036006  | 36 3M 6 - 6F *   | 36  | 34,38 | 33,62 | 38,0 | 26,0 | 10,3 | 18,0 | 6  |  |
|   | 32D040006  | 40 3M 6 - 6F *   | 40  | 38,20 | 37,44 | 42,0 | 28,0 | 10,3 | 18,0 | 6  |  |
|   | 32D044006  | 44 3M 6 - 6F *   | 44  | 42,02 | 41,26 | 48,0 | 33,0 | 10,3 | 18,0 | 6  |  |
|   | 32D048006  | 48 3M 6 - 6 *  | 48  | 45,84 | 45,08 | -    | 33,0 | 10,3 | 18,6 | 8  |  |
|   | 32D060006  | 60 3M 6 - 6 *  | 60  | 57,30 | 56,54 | -    | 33,0 | 10,3 | 18,6 | 8  |  |
|   | 32D072006  | 72 3M 6 - 6 *  | 72  | 68,75 | 67,99 | -    | 33,0 | 10,3 | 18,6 | 8  |  |

\* A richiesta - On request - Auf Anfrage - Sur demande - Bajo consulta.



## Pulegge dentate HTD® monoblocco

Monobloc HTD® timing pulleys  
 Monoblock HTD® Zahnriemenscheiben  
 Poulies dentées HTD® moyeu plein  
 Poleas dentadas HTD® macizas

### HTD® 3M 09 Passo - Pitch - Teilung - Pas - Paso 3 mm

| Materiale<br>Material<br>Werkstoff<br>Matériel<br>Material   | Codice<br>Item number<br>Codierung<br>Code<br>Código | Descrizione<br>Designation<br>Bezeichnung<br>Désignation<br>Referencia | N° denti<br>No. of teeth<br>Anzahl der<br>Zähne<br>Nombre de<br>dents<br>Cantidad de<br>dientes | Dp    | De    | Df   | Dm   | F    | L    | d  | Peso<br>Weight<br>Gewicht<br>Poids<br>Peso |
|--|--|--|---|-------|-------|------|------|------|------|----|--|
|  |  |  |   | mm    | mm    | mm   | mm   | mm   | mm   | mm | kg   |
| Alluminio<br>Aluminium<br>Aluminium<br>Aluminium<br>Aluminio | 32D010009  | 10 3M 9 - 1F   | 10  | 9,55  | 8,79  | 13,0 | 13,0 | 11,5 | 17,5 | -  | 0,004                                      |
|  | 32D012009  | 12 3M 9 - 1F   | 12  | 11,46 | 10,70 | 15,0 | 15,0 | 11,5 | 17,5 | -  | 0,006                                      |
|  | 32D014009  | 14 3M 9 - 1F   | 14  | 13,37 | 12,61 | 16,0 | 16,0 | 11,5 | 17,5 | -  | 0,007                                      |
|  | 32D015009  | 15 3M 9 - 1F   | 15  | 14,32 | 13,56 | 17,5 | 17,5 | 11,5 | 17,5 | -  | 0,008                                      |
|  | 32D016009  | 16 3M 9 - 6F   | 16  | 15,28 | 14,52 | 18,0 | 10,0 | 12,8 | 20,6 | 4  | 0,005                                      |
|  | 32D018009  | 18 3M 9 - 6F   | 18  | 17,19 | 16,43 | 19,5 | 11,0 | 12,8 | 20,6 | 6  | 0,008                                      |
|  | 32D020009  | 20 3M 9 - 6F   | 20  | 19,10 | 18,34 | 23,0 | 13,0 | 12,8 | 20,6 | 6  | 0,011                                      |
|  | 32D021009  | 21 3M 9 - 6F   | 21  | 20,05 | 19,29 | 25,0 | 14,0 | 12,8 | 20,6 | 6  | 0,013                                      |
|  | 32D022009  | 22 3M 9 - 6F   | 22  | 21,01 | 20,25 | 25,0 | 14,0 | 12,8 | 20,6 | 6  | 0,020                                      |
|  | 32D024009  | 24 3M 9 - 6F   | 24  | 22,92 | 22,16 | 25,0 | 14,0 | 12,8 | 20,6 | 6  | 0,015                                      |
|  | 32D026009  | 26 3M 9 - 6F   | 26  | 24,83 | 24,07 | 28,0 | 16,0 | 12,8 | 20,6 | 6  | 0,020                                      |
|  | 32D028009  | 28 3M 9 - 6F   | 28  | 26,74 | 25,98 | 32,0 | 18,0 | 12,8 | 20,6 | 6  | 0,030                                      |
|  | 32D030009  | 30 3M 9 - 6F   | 30  | 28,65 | 27,89 | 32,0 | 20,0 | 12,8 | 20,6 | 6  | 0,027                                      |
|  | 32D032009  | 32 3M 9 - 6F   | 32  | 30,56 | 29,80 | 36,0 | 22,0 | 12,8 | 20,6 | 6  | 0,030                                      |
|  | 32D036009  | 36 3M 9 - 6F   | 36  | 34,38 | 33,62 | 38,0 | 26,0 | 13,4 | 22,2 | 6  | 0,050                                      |
|  | 32D040009  | 40 3M 9 - 6F   | 40  | 38,20 | 37,44 | 42,0 | 28,0 | 13,4 | 22,2 | 6  | 0,060                                      |
|  | 32D044009  | 44 3M 9 - 6F   | 44  | 42,02 | 41,26 | 48,0 | 33,0 | 13,4 | 22,2 | 6  | 0,070                                      |
|  | 32D048009  | 48 3M 9 - 6  | 48  | 45,84 | 45,08 | -    | 33,0 | 13,4 | 22,2 | 8  | 0,070                                      |
|  | 32D060009  | 60 3M 9 - 6  | 60  | 57,30 | 56,54 | -    | 33,0 | 13,4 | 22,2 | 8  | 0,110                                      |
|  | 32D072009  | 72 3M 9 - 6  | 72  | 68,75 | 67,99 | -    | 33,0 | 13,4 | 22,2 | 8  | 0,150                                      |

### HTD® 3M 15 Passo - Pitch - Teilung - Pas - Paso 3 mm

| Materiale<br>Material<br>Werkstoff<br>Matériel<br>Material   | Codice<br>Item number<br>Codierung<br>Code<br>Código | Descrizione<br>Designation<br>Bezeichnung<br>Désignation<br>Referencia | N° denti<br>No. of teeth<br>Anzahl der<br>Zähne<br>Nombre de<br>dents<br>Cantidad de<br>dientes | Dp    | De    | Df   | Dm   | F    | L    | d  | Peso<br>Weight<br>Gewicht<br>Poids<br>Peso |
|--|--|--|---|-------|-------|------|------|------|------|----|--|
|  |  |  |   | mm    | mm    | mm   | mm   | mm   | mm   | mm | kg   |
| Alluminio<br>Aluminium<br>Aluminium<br>Aluminium<br>Aluminio | 32D010015  | 10 3M 15 - 1F  | 10  | 9,55  | 8,79  | 13,0 | 13,0 | 18,0 | 26,0 | -  | 0,003                                      |
|  | 32D012015  | 12 3M 15 - 1F  | 12  | 11,46 | 10,70 | 15,0 | 15,0 | 18,0 | 26,0 | -  | 0,008                                      |
|  | 32D014015  | 14 3M 15 - 1F  | 14  | 13,37 | 12,61 | 16,0 | 16,0 | 18,0 | 26,0 | -  | 0,010                                      |
|  | 32D015015  | 15 3M 15 - 1F  | 15  | 14,32 | 13,56 | 17,5 | 17,5 | 18,0 | 26,0 | -  | 0,006                                      |
|  | 32D016015  | 16 3M 15 - 6F  | 16  | 15,28 | 14,52 | 18,0 | 10,0 | 19,5 | 26,0 | 4  | 0,009                                      |
|  | 32D018015  | 18 3M 15 - 6F  | 18  | 17,19 | 16,43 | 19,5 | 11,0 | 19,5 | 26,0 | 6  | 0,010                                      |
|  | 32D020015  | 20 3M 15 - 6F  | 20  | 19,10 | 18,34 | 23,0 | 13,0 | 19,5 | 26,0 | 6  | 0,014                                      |
|  | 32D021015  | 21 3M 15 - 6F  | 21  | 20,05 | 19,29 | 25,0 | 14,0 | 19,5 | 26,0 | 6  | 0,020                                      |
|  | 32D022015  | 22 3M 15 - 6F  | 22  | 21,01 | 20,25 | 25,0 | 14,0 | 19,5 | 26,0 | 6  | 0,020                                      |
|  | 32D024015  | 24 3M 15 - 6F  | 24  | 22,92 | 22,16 | 25,0 | 14,0 | 19,5 | 26,0 | 6  | 0,030                                      |
|  | 32D026015  | 26 3M 15 - 6F  | 26  | 24,83 | 24,07 | 28,0 | 16,0 | 19,5 | 26,0 | 6  | 0,030                                      |
|  | 32D028015  | 28 3M 15 - 6F  | 28  | 26,74 | 25,98 | 32,0 | 18,0 | 19,5 | 26,0 | 6  | 0,030                                      |
|  | 32D030015  | 30 3M 15 - 6F  | 30  | 28,65 | 27,89 | 32,0 | 20,0 | 19,5 | 26,0 | 6  | 0,040                                      |
|  | 32D032015  | 32 3M 15 - 6F  | 32  | 30,56 | 29,80 | 36,0 | 22,0 | 19,5 | 26,0 | 6  | 0,040                                      |
|  | 32D036015  | 36 3M 15 - 6F  | 36  | 34,38 | 33,62 | 38,0 | 26,0 | 20,0 | 30,0 | 6  | 0,060                                      |
|  | 32D040015  | 40 3M 15 - 6F  | 40  | 38,20 | 37,44 | 42,0 | 28,0 | 20,0 | 30,0 | 6  | 0,080                                      |
|  | 32D044015  | 44 3M 15 - 6F  | 44  | 42,02 | 41,26 | 48,0 | 33,0 | 20,0 | 30,0 | 6  | 0,100                                      |
|  | 32D048015  | 48 3M 15 - 6   | 48  | 45,84 | 45,08 | -    | 33,0 | 20,0 | 30,0 | 8  | 0,100                                      |
|  | 32D060015  | 60 3M 15 - 6   | 60  | 57,30 | 56,54 | -    | 33,0 | 20,0 | 30,0 | 8  | 0,150                                      |
|  | 32D072015  | 72 3M 15 - 6   | 72  | 68,75 | 67,99 | -    | 33,0 | 20,0 | 30,0 | 8  | 0,210                                      |



## Pulegge dentate HTD® monoblocco

Monobloc HTD® timing pulleys  
 Monoblock HTD® Zahnriemenscheiben  
 Poulies dentées HTD® moyeu plein  
 Poleas dentadas HTD® macizas

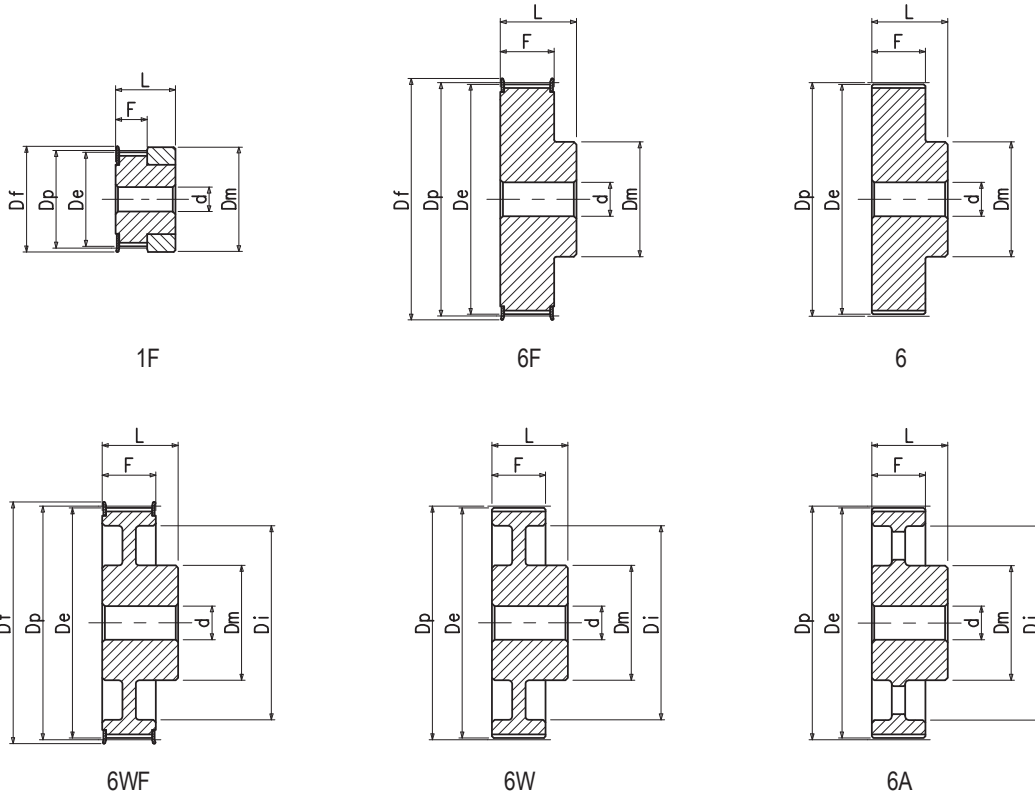

### HTD® 5M 09 Passo - Pitch - Teilung - Pas - Paso 5 mm

| Materiale<br>Material<br>Werkstoff<br>Matériel<br>Material | Codice<br>Item number<br>Codierung<br>Code<br>Código         | Descrizione<br>Designation<br>Bezeichnung<br>Désignation<br>Referencia | N° denti<br>No. of teeth<br>Anzahl der<br>Zähne<br>Nombre de<br>dents<br>Cantidad de<br>dientes | Dp     | De     | Df    | Dm   | Di    | F    | L    | d    | Peso<br>Weight<br>Gewicht<br>Poids<br>Peso<br>kg |
|--|--|--|---|--------|--------|-------|------|-------|------|------|------|--|
|  |  |  |   | mm     | mm     | mm    | mm   | mm    | mm   | mm   |      |  |
| Acciaio<br>Steel<br>Stahl<br>Acier<br>Acero                | 32F012009  | 12 5M 9 - 6F   | 12  | 19,10  | 17,96  | 23,0  | 13,0 | -     | 14,5 | 20,0 | 4    | 0,030  |
|  | 32F014009  | 14 5M 9 - 6F   | 14  | 22,28  | 21,14  | 25,0  | 14,0 | -     | 14,5 | 20,0 | 6    | 0,040  |
|  | 32F015009  | 15 5M 9 - 6F   | 15  | 23,87  | 22,73  | 28,0  | 16,0 | -     | 14,5 | 20,0 | 6    | 0,050  |
|  | 32F016009  | 16 5M 9 - 6F   | 16  | 25,46  | 24,32  | 28,0  | 16,5 | -     | 14,5 | 20,0 | 6    | 0,050  |
|  | 32F018009  | 18 5M 9 - 6F   | 18  | 28,65  | 27,51  | 32,0  | 20,0 | -     | 14,5 | 20,0 | 6    | 0,070  |
|  | 32F020009  | 20 5M 9 - 6F   | 20  | 31,83  | 30,69  | 36,0  | 23,0 | -     | 14,5 | 22,5 | 6    | 0,100  |
|  | 32F021009  | 21 5M 9 - 6F   | 21  | 33,42  | 32,28  | 38,0  | 24,0 | -     | 14,5 | 22,5 | 6    | 0,110  |
|  | 32F022009  | 22 5M 9 - 6F   | 22  | 35,01  | 33,87  | 38,0  | 25,5 | -     | 14,5 | 22,5 | 6    | 0,120  |
|  | 32F024009  | 24 5M 9 - 6F   | 24  | 38,20  | 37,06  | 42,0  | 27,0 | -     | 14,5 | 22,5 | 6    | 0,140  |
|  | 32F026009  | 26 5M 9 - 6F   | 26  | 41,38  | 40,24  | 44,0  | 30,0 | -     | 14,5 | 22,5 | 6    | 0,170  |
|  | 32F028009  | 28 5M 9 - 6F   | 28  | 44,56  | 43,42  | 48,0  | 30,5 | -     | 14,5 | 22,5 | 6    | 0,200  |
|  | 32F030009  | 30 5M 9 - 6F   | 30  | 47,75  | 46,60  | 51,0  | 35,0 | -     | 14,5 | 22,5 | 6    | 0,240  |
|  | 32F032009  | 32 5M 9 - 6F   | 32  | 50,93  | 49,79  | 54,0  | 38,0 | -     | 14,5 | 22,5 | 8    | 0,270  |
|  | 32F036009  | 36 5M 9 - 6F   | 36  | 57,30  | 56,16  | 60,0  | 38,0 | -     | 14,5 | 22,5 | 8    | 0,330  |
|  | 32F040009  | 40 5M 9 - 6F   | 40  | 63,66  | 62,52  | 71,0  | 38,0 | -     | 14,5 | 22,5 | 8    | 0,400  |
|  | Alluminio<br>Aluminium<br>Aluminium<br>Aluminium<br>Aluminio | 32F044009  | 44 5M 9 - 6W  | 44     | 70,03  | 68,89 | -    | 38,0  | 58,5 | 14,5 | 25,5 | 8  |
| 32F048009  |  | 48 5M 9 - 6W   | 48  | 76,39  | 75,25  | -     | 45,0 | 61,0  | 14,5 | 25,5 | 8    | 0,180  |
| 32F060009  |  | 60 5M 9 - 6W   | 60  | 95,49  | 94,35  | -     | 45,0 | 80,0  | 14,5 | 25,5 | 8    | 0,220  |
| 32F072009  |  | 72 5M 9 - 6W   | 72  | 114,59 | 113,45 | -     | 45,0 | 100,0 | 14,5 | 25,5 | 8    | 0,260  |



## Pulegge dentate HTD® monoblocco

Monobloc HTD® timing pulleys  
 Monoblock HTD® Zahnriemenscheiben  
 Poulies dentées HTD® moyeu plein  
 Poleas dentadas HTD® macizas

### HTD® 5M 15 Passo - Pitch - Teilung - Pas - Paso 5 mm

| Materiale<br>Material<br>Werkstoff<br>Matériel<br>Material | Code<br>Item number<br>Codierung<br>Code<br>Código           | Descrizione<br>Designation<br>Bezeichnung<br>Désignation<br>Referencia | N° denti<br>No. of teeth<br>Anzahl der<br>Zähne<br>Nombre de<br>dents<br>Cantidad de<br>dientes | Dp     | De     | Df    | Dm   | Di    | F    | L    | d    | Peso<br>Weight<br>Gewicht<br>Poids<br>Peso |
|--|--|--|---|--------|--------|-------|------|-------|------|------|------|--|
|  |  |  |   | mm     | mm     | mm    | mm   | mm    | mm   | mm   | mm   | kg   |
| Acciaio<br>Steel<br>Stahl<br>Acier<br>Acero                | 32F012015  | 12 5M 15 - 6F  | 12  | 19,10  | 17,96  | 23,0  | 13,0 | -     | 20,5 | 26,0 | 4    | 0,040                                      |
|  | 32F014015  | 14 5M 15 - 6F  | 14  | 22,28  | 21,14  | 25,0  | 14,0 | -     | 20,5 | 26,0 | 6    | 0,050                                      |
|  | 32F015015  | 15 5M 15 - 6F  | 15  | 23,87  | 22,73  | 28,0  | 16,0 | -     | 20,5 | 26,0 | 6    | 0,060                                      |
|  | 32F016015  | 16 5M 15 - 6F  | 16  | 25,46  | 24,32  | 28,0  | 16,5 | -     | 20,5 | 26,0 | 6    | 0,070                                      |
|  | 32F018015  | 18 5M 15 - 6F  | 18  | 28,65  | 27,51  | 32,0  | 20,0 | -     | 20,5 | 26,0 | 6    | 0,090                                      |
|  | 32F020015  | 20 5M 15 - 6F  | 20  | 31,83  | 30,69  | 36,0  | 23,0 | -     | 20,5 | 26,0 | 6    | 0,120                                      |
|  | 32F021015  | 21 5M 15 - 6F  | 21  | 33,42  | 32,28  | 38,0  | 24,0 | -     | 20,5 | 26,0 | 6    | 0,130                                      |
|  | 32F022015  | 22 5M 15 - 6F  | 22  | 35,01  | 33,87  | 38,0  | 25,5 | -     | 20,5 | 26,0 | 6    | 0,140                                      |
|  | 32F024015  | 24 5M 15 - 6F  | 24  | 38,20  | 37,06  | 42,0  | 27,0 | -     | 20,5 | 28,0 | 6    | 0,180                                      |
|  | 32F026015  | 26 5M 15 - 6F  | 26  | 41,38  | 40,24  | 44,0  | 30,0 | -     | 20,5 | 28,0 | 6    | 0,220                                      |
|  | 32F028015  | 28 5M 15 - 6F  | 28  | 44,56  | 43,42  | 48,0  | 30,5 | -     | 20,5 | 28,0 | 6    | 0,250                                      |
|  | 32F030015  | 30 5M 15 - 6F  | 30  | 47,75  | 46,60  | 51,0  | 35,0 | -     | 20,5 | 28,0 | 6    | 0,300                                      |
|  | 32F032015  | 32 5M 15 - 6F  | 32  | 50,93  | 49,79  | 54,0  | 38,0 | -     | 20,5 | 28,0 | 8    | 0,350                                      |
|  | 32F036015  | 36 5M 15 - 6F  | 36  | 57,30  | 56,16  | 60,0  | 38,0 | -     | 20,5 | 28,0 | 8    | 0,430                                      |
|  | 32F040015  | 40 5M 15 - 6F  | 40  | 63,66  | 62,52  | 71,0  | 38,0 | -     | 20,5 | 28,0 | 8    | 0,520                                      |
|  | Alluminio<br>Aluminium<br>Aluminium<br>Aluminium<br>Aluminio | 32F044015  | 44 5M 15 - 6W   | 44     | 70,03  | 68,89 | -    | 38,0  | 56,5 | 20,5 | 30,0 | 8  |
| 32F048015  |  | 48 5M 15 - 6W  | 48  | 76,39  | 75,25  | -     | 38,0 | 61,0  | 20,5 | 30,0 | 8    | 0,190                                      |
| 32F060015  |  | 60 5M 15 - 6W  | 60  | 95,49  | 94,35  | -     | 50,0 | 80,0  | 20,5 | 30,0 | 8    | 0,300                                      |
| 32F072015  |  | 72 5M 15 - 6W  | 72  | 114,59 | 113,45 | -     | 50,0 | 100,0 | 20,5 | 30,0 | 8    | 0,380                                      |

### HTD® 5M 25 Passo - Pitch - Teilung - Pas - Paso 5 mm

| Materiale<br>Material<br>Werkstoff<br>Matériel<br>Material | Code<br>Item number<br>Codierung<br>Code<br>Código           | Descrizione<br>Designation<br>Bezeichnung<br>Désignation<br>Referencia | N° denti<br>No. of teeth<br>Anzahl der<br>Zähne<br>Nombre de<br>dents<br>Cantidad de<br>dientes | Dp     | De     | Df    | Dm   | Di    | F    | L    | d    | Peso<br>Weight<br>Gewicht<br>Poids<br>Peso |
|--|--|--|---|--------|--------|-------|------|-------|------|------|------|--|
|  |  |  |   | mm     | mm     | mm    | mm   | mm    | mm   | mm   | mm   | kg   |
| Acciaio<br>Steel<br>Stahl<br>Acier<br>Acero                | 32F012025  | 12 5M 25 - 6F  | 12  | 19,10  | 17,96  | 23,0  | 13,0 | -     | 30,0 | 36,0 | 4    | 0,050                                      |
|  | 32F014025  | 14 5M 25 - 6F  | 14  | 22,28  | 21,14  | 25,0  | 14,0 | -     | 30,0 | 36,0 | 6    | 0,070                                      |
|  | 32F015025  | 15 5M 25 - 6F  | 15  | 23,87  | 22,73  | 28,0  | 16,0 | -     | 30,0 | 36,0 | 6    | 0,080                                      |
|  | 32F016025  | 16 5M 25 - 6F  | 16  | 25,46  | 24,32  | 28,0  | 16,5 | -     | 30,0 | 36,0 | 6    | 0,100                                      |
|  | 32F018025  | 18 5M 25 - 6F  | 18  | 28,65  | 27,51  | 32,0  | 20,0 | -     | 30,0 | 36,0 | 6    | 0,120                                      |
|  | 32F020025  | 20 5M 25 - 6F  | 20  | 31,83  | 30,69  | 36,0  | 23,0 | -     | 30,0 | 36,0 | 6    | 0,160                                      |
|  | 32F021025  | 21 5M 25 - 6F  | 21  | 33,42  | 32,28  | 38,0  | 24,0 | -     | 30,0 | 38,0 | 6    | 0,190                                      |
|  | 32F022025  | 22 5M 25 - 6F  | 22  | 35,01  | 33,87  | 38,0  | 25,5 | -     | 30,0 | 38,0 | 6    | 0,210                                      |
|  | 32F024025  | 24 5M 25 - 6F  | 24  | 38,20  | 37,06  | 42,0  | 27,0 | -     | 30,0 | 38,0 | 6    | 0,250                                      |
|  | 32F026025  | 26 5M 25 - 6F  | 26  | 41,38  | 40,24  | 44,0  | 30,0 | -     | 30,0 | 38,0 | 6    | 0,300                                      |
|  | 32F028025  | 28 5M 25 - 6F  | 28  | 44,56  | 43,42  | 48,0  | 30,5 | -     | 30,0 | 38,0 | 6    | 0,350                                      |
|  | 32F030025  | 30 5M 25 - 6F  | 30  | 47,75  | 46,60  | 51,0  | 35,0 | -     | 30,0 | 38,0 | 6    | 0,420                                      |
|  | 32F032025  | 32 5M 25 - 6F  | 32  | 50,93  | 49,79  | 54,0  | 38,0 | -     | 30,0 | 38,0 | 8    | 0,480                                      |
|  | 32F036025  | 36 5M 25 - 6F  | 36  | 57,30  | 56,16  | 60,0  | 38,0 | -     | 30,0 | 38,0 | 8    | 0,590                                      |
|  | 32F040025  | 40 5M 25 - 6F  | 40  | 63,66  | 62,52  | 71,0  | 38,0 | -     | 30,0 | 38,0 | 8    | 0,740                                      |
|  | Alluminio<br>Aluminium<br>Aluminium<br>Aluminium<br>Aluminio | 32F044025  | 44 5M 25 - 6  | 44     | 70,03  | 68,89 | -    | 38,0  | -    | 30,0 | 40,0 | 8  |
| 32F048025  |  | 48 5M 25 - 6W  | 48  | 76,39  | 75,25  | -     | 38,0 | 61,0  | 30,0 | 40,0 | 8    | 0,280                                      |
| 32F060025  |  | 60 5M 25 - 6W  | 60  | 95,49  | 94,35  | -     | 50,0 | 80,0  | 30,0 | 40,0 | 8    | 0,430                                      |
| 32F072025  |  | 72 5M 25 - 6W  | 72  | 114,59 | 113,45 | -     | 50,0 | 100,0 | 30,0 | 40,0 | 8    | 0,520                                      |



## Pulegge dentate HTD® monoblocco

Monobloc HTD® timing pulleys  
 Monoblock HTD® Zahnriemenscheiben  
 Poulies dentées HTD® moyeu plein  
 Poleas dentadas HTD® macizas

### HTD® 8M 20 Passo - Pitch - Teilung - Pas - Paso 8 mm

| Materiale<br>Material<br>Werkstoff<br>Matériel<br>Material | Code<br>Item number<br>Codierung<br>Code<br>Código | Descrizione<br>Designation<br>Bezeichnung<br>Désignation<br>Referencia | N° denti<br>No. of teeth<br>Anzahl der<br>Zähne<br>Nombre de<br>dents<br>Cantidad de<br>dientes | Dp     | De     | Df    | Dm    | Di    | F    | L    | d  | Peso<br>Weight<br>Gewicht<br>Poids<br>Peso |
|--|--|--|---|--------|--------|-------|-------|-------|------|------|----|--|
|  |  |  |   | mm     | mm     | mm    | mm    | mm    | mm   | mm   | mm | kg   |
| Acciaio<br>Steel<br>Stahl<br>Acier<br>Acero                | 32G022020  | 22 8M 20 - 6F  | 22  | 56,02  | 54,65  | 60,0  | 43,0  | -     | 28,0 | 38,0 | 12 | 0,54                                       |
|  | 32G024020  | 24 8M 20 - 6F  | 24  | 61,12  | 59,75  | 66,0  | 45,0  | -     | 28,0 | 38,0 | 12 | 0,65                                       |
|  | 32G026020  | 26 8M 20 - 6F  | 26  | 66,21  | 64,84  | 71,0  | 50,0  | -     | 28,0 | 38,0 | 12 | 0,80                                       |
|  | 32G028020  | 28 8M 20 - 6F  | 28  | 71,30  | 70,08  | 75,0  | 50,0  | -     | 28,0 | 38,0 | 15 | 0,87                                       |
|  | 32G030020  | 30 8M 20 - 6F  | 30  | 76,39  | 75,13  | 83,0  | 55,0  | -     | 28,0 | 38,0 | 15 | 1,02                                       |
|  | 32G032020  | 32 8M 20 - 6F  | 32  | 81,49  | 80,16  | 87,0  | 60,0  | -     | 28,0 | 38,0 | 15 | 1,20                                       |
|  | 32G034020  | 34 8M 20 - 6F  | 34  | 86,58  | 85,22  | 91,0  | 70,0  | -     | 28,0 | 38,0 | 15 | 1,40                                       |
|  | 32G036020  | 36 8M 20 - 6F  | 36  | 91,67  | 90,30  | 98,5  | 70,0  | -     | 28,0 | 38,0 | 15 | 1,55                                       |
|  | 32G038020  | 38 8M 20 - 6F  | 38  | 96,77  | 95,39  | 103,0 | 75,0  | -     | 28,0 | 38,0 | 15 | 1,75                                       |
| Ghisa<br>Cast Iron<br>Grauguss<br>Fonte<br>Fundición       | 32G040020  | 40 8M 20 - 6F  | 40  | 101,86 | 100,49 | 106,0 | 75,0  | -     | 28,0 | 38,0 | 15 | 1,76                                       |
|  | 32G044020  | 44 8M 20 - 6F  | 44  | 112,05 | 110,67 | 119,0 | 75,0  | -     | 28,0 | 38,0 | 15 | 2,10                                       |
|  | 32G048020  | 48 8M 20 - 6F  | 48  | 122,23 | 120,86 | 127,0 | 75,0  | -     | 28,0 | 38,0 | 15 | 2,44                                       |
|  | 32G056020  | 56 8M 20 - 6WF   | 56  | 142,60 | 141,23 | 148,0 | 80,0  | 117,0 | 28,0 | 38,0 | 15 | 2,55                                       |
|  | 32G064020  | 64 8M 20 - 6WF   | 64  | 162,97 | 161,60 | 168,0 | 80,0  | 137,0 | 28,0 | 38,0 | 15 | 2,93                                       |
|  | 32G072020  | 72 8M 20 - 6WF   | 72  | 183,35 | 181,97 | 192,0 | 80,0  | 158,0 | 28,0 | 38,0 | 15 | 3,54                                       |
|  | 32G080020  | 80 8M 20 - 6A  | 80  | 203,72 | 202,35 | -     | 90,0  | 180,0 | 28,0 | 38,0 | 15 | 3,80                                       |
|  | 32G090020  | 90 8M 20 - 6A  | 90  | 229,18 | 227,81 | -     | 90,0  | 204,0 | 28,0 | 38,0 | 15 | 4,20                                       |
|  | 32G112020  | 112 8M 20 - 6A   | 112   | 285,21 | 283,83 | -     | 90,0  | 260,0 | 28,0 | 38,0 | 18 | 5,20                                       |
|  | 32G144020  | 144 8M 20 - 6A   | 144   | 366,69 | 365,32 | -     | 90,0  | 341,0 | 28,0 | 38,0 | 20 | 7,50                                       |
|  | 32G168020  | 168 8M 20 - 6A   | 168   | 427,81 | 426,44 | -     | 100,0 | 402,0 | 28,0 | 38,0 | 20 | 10,00                                      |
|  | 32G192020  | 192 8M 20 - 6A   | 192   | 488,92 | 487,55 | -     | 100,0 | 460,0 | 28,0 | 38,0 | 20 | 14,40                                      |

### HTD® 8M 30 Passo - Pitch - Teilung - Pas - Paso 8 mm

| Materiale<br>Material<br>Werkstoff<br>Matériel<br>Material | Code<br>Item number<br>Codierung<br>Code<br>Código | Descrizione<br>Designation<br>Bezeichnung<br>Désignation<br>Referencia | N° denti<br>No. of teeth<br>Anzahl der<br>Zähne<br>Nombre de<br>dents<br>Cantidad de<br>dientes | Dp     | De     | Df    | Dm    | Di    | F    | L    | d  | Peso<br>Weight<br>Gewicht<br>Poids<br>Peso |
|--|--|--|---|--------|--------|-------|-------|-------|------|------|----|--|
|  |  |  |   | mm     | mm     | mm    | mm    | mm    | mm   | mm   | mm | kg   |
| Acciaio<br>Steel<br>Stahl<br>Acier<br>Acero                | 32G022030  | 22 8M 30 - 6F  | 22  | 56,02  | 54,65  | 60,0  | 43,0  | -     | 38,0 | 48,0 | 12 | 0,69                                       |
|  | 32G024030  | 24 8M 30 - 6F  | 24  | 61,12  | 59,75  | 66,0  | 45,0  | -     | 38,0 | 48,0 | 12 | 0,84                                       |
|  | 32G026030  | 26 8M 30 - 6F  | 26  | 66,21  | 64,84  | 71,0  | 50,0  | -     | 38,0 | 48,0 | 12 | 1,00                                       |
|  | 32G028030  | 28 8M 30 - 6F  | 28  | 71,30  | 70,08  | 75,0  | 50,0  | -     | 38,0 | 48,0 | 15 | 1,12                                       |
|  | 32G030030  | 30 8M 30 - 6F  | 30  | 76,39  | 75,13  | 83,0  | 55,0  | -     | 38,0 | 48,0 | 15 | 1,32                                       |
|  | 32G032030  | 32 8M 30 - 6F  | 32  | 81,49  | 80,16  | 87,0  | 60,0  | -     | 38,0 | 48,0 | 15 | 1,53                                       |
|  | 32G034030  | 34 8M 30 - 6F  | 34  | 86,58  | 85,22  | 91,0  | 70,0  | -     | 38,0 | 48,0 | 15 | 1,80                                       |
|  | 32G036030  | 36 8M 30 - 6F  | 36  | 91,67  | 90,30  | 98,5  | 70,0  | -     | 38,0 | 48,0 | 15 | 1,99                                       |
|  | 32G038030  | 38 8M 30 - 6F  | 38  | 96,77  | 95,39  | 103,0 | 75,0  | -     | 38,0 | 48,0 | 15 | 2,27                                       |
| Ghisa<br>Cast Iron<br>Grauguss<br>Fonte<br>Fundición       | 32G040030  | 40 8M 30 - 6F  | 40  | 101,86 | 100,49 | 106,0 | 75,0  | -     | 38,0 | 48,0 | 15 | 2,40                                       |
|  | 32G044030  | 44 8M 30 - 6F  | 44  | 112,05 | 110,67 | 119,0 | 75,0  | -     | 38,0 | 48,0 | 15 | 2,70                                       |
|  | 32G048030  | 48 8M 30 - 6F  | 48  | 122,23 | 120,86 | 127,0 | 75,0  | -     | 38,0 | 48,0 | 15 | 3,20                                       |
|  | 32G056030  | 56 8M 30 - 6WF   | 56  | 142,60 | 141,23 | 148,0 | 90,0  | 117,0 | 38,0 | 48,0 | 15 | 3,70                                       |
|  | 32G064030  | 64 8M 30 - 6WF   | 64  | 162,97 | 161,60 | 168,0 | 90,0  | 137,0 | 38,0 | 48,0 | 15 | 4,10                                       |
|  | 32G072030  | 72 8M 30 - 6WF   | 72  | 183,35 | 181,97 | 192,0 | 90,0  | 158,0 | 38,0 | 48,0 | 15 | 4,80                                       |
|  | 32G080030  | 80 8M 30 - 6A  | 80  | 203,72 | 202,35 | -     | 100,0 | 180,0 | 38,0 | 48,0 | 15 | 5,10                                       |
|  | 32G090030  | 90 8M 30 - 6A  | 90  | 229,18 | 227,81 | -     | 100,0 | 204,0 | 38,0 | 48,0 | 15 | 5,70                                       |
|  | 32G112030  | 112 8M 30 - 6A   | 112   | 285,21 | 283,83 | -     | 100,0 | 260,0 | 38,0 | 48,0 | 18 | 6,80                                       |
|  | 32G144030  | 144 8M 30 - 6A   | 144   | 366,69 | 365,32 | -     | 100,0 | 341,0 | 38,0 | 48,0 | 20 | 9,30                                       |
|  | 32G168030  | 168 8M 30 - 6A   | 168   | 427,81 | 426,44 | -     | 100,0 | 402,0 | 38,0 | 48,0 | 20 | 11,40                                      |
|  | 32G192030  | 192 8M 30 - 6A   | 192   | 488,92 | 487,55 | -     | 100,0 | 460,0 | 38,0 | 48,0 | 20 | 16,00                                      |



## Pulegge dentate HTD® monoblocco

Monobloc HTD® timing pulleys  
 Monoblock HTD® Zahnriemenscheiben  
 Poulies dentées HTD® moyeu plein  
 Poleas dentadas HTD® macizas

### HTD® 8M 50 Passo - Pitch - Teilung - Pas - Paso 8 mm

| Materiale<br>Material<br>Werkstoff<br>Matériel<br>Material | Code<br>Item number<br>Codierung<br>Code<br>Código | Descrizione<br>Designation<br>Bezeichnung<br>Désignation<br>Referencia | N° denti<br>No. of teeth<br>Anzahl der<br>Zähne<br>Nombre de<br>dents<br>Cantidad de<br>dientes | Dp     | De     | Df    | Dm    | Di    | F    | L    | d  | Peso<br>Weight<br>Gewicht<br>Poids<br>Peso |
|--|--|--|---|--------|--------|-------|-------|-------|------|------|----|--|
|  |  |  |   | mm     | mm     | mm    | mm    | mm    | mm   | mm   | mm | kg   |
| Acciaio<br>Steel<br>Stahl<br>Acier<br>Acero                | 32G022050  | 22 8M 50 - 6F  | 22  | 56,02  | 54,65  | 60,0  | 43,0  | -     | 60,0 | 70,0 | 12 | 1,00                                       |
|  | 32G024050  | 24 8M 50 - 6F  | 24  | 61,12  | 59,75  | 66,0  | 45,0  | -     | 60,0 | 70,0 | 12 | 1,23                                       |
|  | 32G026050  | 26 8M 50 - 6F  | 26  | 66,21  | 64,84  | 71,0  | 50,0  | -     | 60,0 | 70,0 | 12 | 1,50                                       |
|  | 32G028050  | 28 8M 50 - 6F  | 28  | 71,30  | 70,08  | 75,0  | 50,0  | -     | 60,0 | 70,0 | 15 | 1,67                                       |
|  | 32G030050  | 30 8M 50 - 6F  | 30  | 76,39  | 75,13  | 83,0  | 55,0  | -     | 60,0 | 70,0 | 15 | 1,97                                       |
|  | 32G032050  | 32 8M 50 - 6F  | 32  | 81,49  | 80,16  | 87,0  | 60,0  | -     | 60,0 | 70,0 | 15 | 2,27                                       |
|  | 32G034050  | 34 8M 50 - 6F  | 34  | 86,58  | 85,22  | 91,0  | 70,0  | -     | 60,0 | 70,0 | 15 | 2,64                                       |
|  | 32G036050  | 36 8M 50 - 6F  | 36  | 91,67  | 90,30  | 98,5  | 70,0  | -     | 60,0 | 70,0 | 15 | 2,97                                       |
|  | 32G038050  | 38 8M 50 - 6F  | 38  | 96,77  | 95,39  | 103,0 | 75,0  | -     | 60,0 | 70,0 | 15 | 3,35                                       |
| Ghisa<br>Cast iron<br>Grauguß<br>Fonte<br>Fundición        | 32G040050  | 40 8M 50 - 6F  | 40  | 101,86 | 100,49 | 106,0 | 75,0  | -     | 60,0 | 70,0 | 18 | 3,30                                       |
|  | 32G044050  | 44 8M 50 - 6F  | 44  | 112,05 | 110,67 | 119,0 | 75,0  | -     | 60,0 | 70,0 | 18 | 4,05                                       |
|  | 32G048050  | 48 8M 50 - 6F  | 48  | 122,23 | 120,86 | 127,0 | 75,0  | -     | 60,0 | 70,0 | 18 | 4,80                                       |
|  | 32G056050  | 56 8M 50 - 10WF  | 56  | 142,60 | 141,23 | 148,0 | 90,0  | 117,0 | 60,0 | 60,0 | 18 | 5,20                                       |
|  | 32G064050  | 64 8M 50 - 10WF  | 64  | 162,97 | 161,60 | 168,0 | 100,0 | 137,0 | 60,0 | 60,0 | 18 | 5,60                                       |
|  | 32G072050  | 72 8M 50 - 10WF  | 72  | 183,35 | 181,97 | 192,0 | 100,0 | 158,0 | 60,0 | 60,0 | 18 | 6,80                                       |
|  | 32G080050  | 80 8M 50 - 10A   | 80  | 203,72 | 202,35 | -     | 110,0 | 180,0 | 60,0 | 60,0 | 18 | 7,50                                       |
|  | 32G090050  | 90 8M 50 - 10A   | 90  | 229,18 | 227,81 | -     | 110,0 | 204,0 | 60,0 | 60,0 | 18 | 8,60                                       |
|  | 32G112050  | 112 8M 50 - 10A  | 112   | 285,21 | 283,83 | -     | 110,0 | 260,0 | 60,0 | 60,0 | 18 | 9,60                                       |
|  | 32G144050  | 144 8M 50 - 10A  | 144   | 366,69 | 365,32 | -     | 110,0 | 341,0 | 60,0 | 60,0 | 20 | 13,80                                      |
|  | 32G168050  | 168 8M 50 - 10A  | 168   | 427,81 | 426,44 | -     | 120,0 | 402,0 | 60,0 | 60,0 | 20 | 16,00                                      |
|  | 32G192050  | 192 8M 50 - 10A  | 192   | 488,92 | 487,55 | -     | 130,0 | 460,0 | 60,0 | 60,0 | 20 | 22,80                                      |

### HTD® 8M 85 Passo - Pitch - Teilung - Pas - Paso 8 mm

| Materiale<br>Material<br>Werkstoff<br>Matériel<br>Material | Code<br>Item number<br>Codierung<br>Code<br>Código | Descrizione<br>Designation<br>Bezeichnung<br>Désignation<br>Referencia | N° denti<br>No. of teeth<br>Anzahl der<br>Zähne<br>Nombre de<br>dents<br>Cantidad de<br>dientes | Dp     | De     | Df    | Dm    | Di    | F    | L     | d  | Peso<br>Weight<br>Gewicht<br>Poids<br>Peso |
|--|--|--|---|--------|--------|-------|-------|-------|------|-------|----|--|
|  |  |  |   | mm     | mm     | mm    | mm    | mm    | mm   | mm    | mm | kg   |
| Acciaio<br>Steel<br>Stahl<br>Acier<br>Acero                | 32G022085  | 22 8M 85 - 6F  | 22  | 56,02  | 54,65  | 60,0  | 43,0  | -     | 95,0 | 105,0 | 12 | 1,55                                       |
|  | 32G024085  | 24 8M 85 - 6F  | 24  | 61,12  | 59,75  | 66,0  | 45,0  | -     | 95,0 | 105,0 | 12 | 1,90                                       |
|  | 32G026085  | 26 8M 85 - 6F  | 26  | 66,21  | 64,84  | 71,0  | 50,0  | -     | 95,0 | 105,0 | 12 | 2,25                                       |
|  | 32G028085  | 28 8M 85 - 6F  | 28  | 71,30  | 70,08  | 75,0  | 50,0  | -     | 95,0 | 105,0 | 15 | 2,55                                       |
|  | 32G030085  | 30 8M 85 - 6F  | 30  | 76,39  | 75,13  | 83,0  | 55,0  | -     | 95,0 | 105,0 | 15 | 3,00                                       |
|  | 32G032085  | 32 8M 85 - 6F  | 32  | 81,49  | 80,16  | 87,0  | 60,0  | -     | 95,0 | 105,0 | 15 | 3,57                                       |
|  | 32G034085  | 34 8M 85 - 6F  | 34  | 86,58  | 85,22  | 91,0  | 70,0  | -     | 95,0 | 105,0 | 15 | 4,00                                       |
|  | 32G036085  | 36 8M 85 - 6F  | 36  | 91,67  | 90,30  | 98,5  | 70,0  | -     | 95,0 | 105,0 | 15 | 4,50                                       |
|  | 32G038085  | 38 8M 85 - 6F  | 38  | 96,77  | 95,39  | 103,0 | 75,0  | -     | 95,0 | 105,0 | 15 | 5,08                                       |
| Ghisa<br>Cast iron<br>Grauguß<br>Fonte<br>Fundición        | 32G040085  | 40 8M 85 - 6F  | 40  | 101,86 | 100,49 | 106,0 | 75,0  | -     | 95,0 | 105,0 | 18 | 5,12                                       |
|  | 32G044085  | 44 8M 85 - 6F  | 44  | 112,05 | 110,67 | 119,0 | 75,0  | -     | 95,0 | 105,0 | 18 | 6,60                                       |
|  | 32G048085  | 48 8M 85 - 6F  | 48  | 122,23 | 120,86 | 127,0 | 75,0  | -     | 95,0 | 105,0 | 18 | 7,40                                       |
|  | 32G056085  | 56 8M 85 - 6F  | 56  | 142,60 | 141,23 | 148,0 | 80,0  | -     | 95,0 | 105,0 | 20 | 10,15                                      |
|  | 32G064085  | 64 8M 85 - 10WF  | 64  | 162,97 | 161,60 | 168,0 | 100,0 | 137,0 | 95,0 | 95,0  | 20 | 10,30                                      |
|  | 32G072085  | 72 8M 85 - 10WF  | 72  | 183,35 | 181,97 | 192,0 | 110,0 | 158,0 | 95,0 | 95,0  | 20 | 11,40                                      |
|  | 32G080085  | 80 8M 85 - 10A   | 80  | 203,72 | 202,35 | -     | 110,0 | 180,0 | 95,0 | 95,0  | 20 | 11,10                                      |
|  | 32G090085  | 90 8M 85 - 10A   | 90  | 229,18 | 227,81 | -     | 110,0 | 204,0 | 95,0 | 95,0  | 20 | 12,80                                      |
|  | 32G112085  | 112 8M 85 - 10A  | 112   | 285,21 | 283,83 | -     | 110,0 | 260,0 | 95,0 | 95,0  | 24 | 15,00                                      |
|  | 32G144085  | 144 8M 85 - 10A  | 144   | 366,69 | 365,32 | -     | 120,0 | 341,0 | 95,0 | 95,0  | 24 | 20,80                                      |
|  | 32G168085  | 168 8M 85 - 10A  | 168   | 427,81 | 426,44 | -     | 120,0 | 402,0 | 95,0 | 95,0  | 24 | 24,10                                      |
|  | 32G192085  | 192 8M 85 - 10A  | 192   | 488,92 | 487,55 | -     | 130,0 | 460,0 | 95,0 | 95,0  | 24 | 30,60                                      |





## Pulegge dentate HTD® monoblocco

Monobloc HTD® timing pulleys  
 Monoblock HTD® Zahnriemenscheiben  
 Poulies dentées HTD® moyeu plein  
 Poleas dentadas HTD® macizas

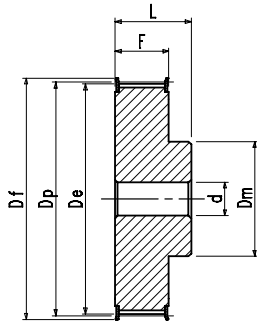

6F

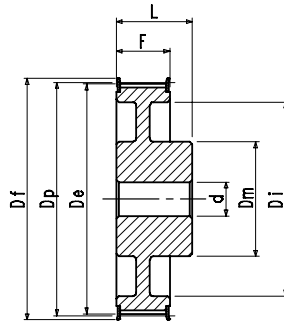

6WF

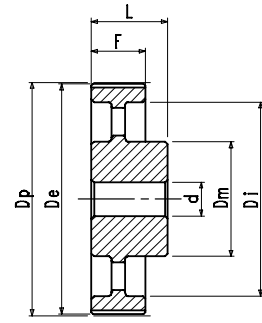

6A

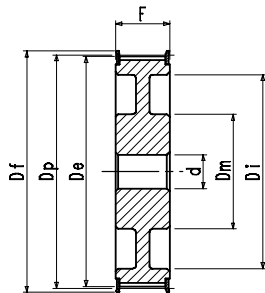

10WF

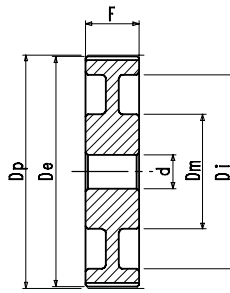

10W

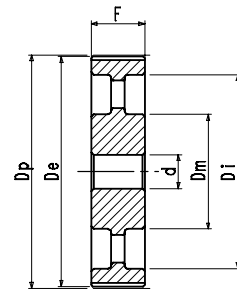

10A

### HTD® 14M 40 Passo - Pitch - Teilung - Pas - Paso 14 mm

| Materiale<br>Material<br>Werkstoff<br>Matériel<br>Material | Codice<br>Item number<br>Codierung<br>Code<br>Código | Descrizione<br>Designation<br>Bezeichnung<br>Désignation<br>Referencia | N° denti<br>No. of teeth<br>Anzahl der<br>Zähne<br>Nombre de<br>dents<br>Cantidad de<br>dientes | Dp     | De     | Df    | Dm    | Di    | F    | L    | d  | Peso<br>Weight<br>Gewicht<br>Poids<br>Peso<br>kg |
|--|--|--|---|--------|--------|-------|-------|-------|------|------|----|--|
|  |  |  |   | mm     | mm     | mm    | mm    | mm    | mm   | mm   | mm |  |
| Ghisa<br>Cast iron<br>Grauguß<br>Fonte<br>Fundición        | 32I028040  | 28 14M 40 - 6F   | 28  | 124,78 | 122,12 | 127,0 | 100,0 | -     | 54,0 | 69,0 | 24 | 4,73   |
|  | 32I029040  | 29 14M 40 - 6F   | 29  | 129,23 | 126,57 | 138,0 | 100,0 | -     | 54,0 | 69,0 | 24 | 5,15   |
|  | 32I030040  | 30 14M 40 - 6F   | 30  | 133,69 | 130,99 | 138,0 | 100,0 | -     | 54,0 | 69,0 | 24 | 5,40   |
|  | 32I032040  | 32 14M 40 - 6F   | 32  | 142,60 | 139,88 | 154,0 | 100,0 | -     | 54,0 | 69,0 | 24 | 6,50   |
|  | 32I034040  | 34 14M 40 - 6F   | 34  | 151,52 | 148,79 | 160,0 | 100,0 | -     | 54,0 | 69,0 | 24 | 6,60   |
|  | 32I036040  | 36 14M 40 - 6F   | 36  | 160,43 | 157,68 | 168,0 | 100,0 | -     | 54,0 | 69,0 | 24 | 7,70   |
|  | 32I038040  | 38 14M 40 - 6F   | 38  | 169,34 | 166,60 | 183,0 | 120,0 | -     | 54,0 | 69,0 | 24 | 9,00   |
|  | 32I040040  | 40 14M 40 - 6F   | 40  | 178,25 | 175,49 | 188,0 | 120,0 | -     | 54,0 | 69,0 | 24 | 9,60   |
|  | 32I044040  | 44 14M 40 - 6F   | 44  | 196,08 | 193,28 | 211,0 | 120,0 | -     | 54,0 | 69,0 | 24 | 11,80  |
|  | 32I048040  | 48 14M 40 - 6WF  | 48  | 213,90 | 211,11 | 226,0 | 135,0 | 172,0 | 54,0 | 69,0 | 24 | 12,00  |
|  | 32I056040  | 56 14M 40 - 6WF  | 56  | 249,55 | 246,76 | 256,0 | 135,0 | 207,0 | 54,0 | 69,0 | 28 | 14,00  |
|  | 32I064040  | 64 14M 40 - 6WF  | 64  | 285,21 | 282,41 | 296,0 | 135,0 | 242,0 | 54,0 | 69,0 | 28 | 16,50  |
|  | 32I072040  | 72 14M 40 - 6A   | 72  | 320,86 | 318,06 | -     | 135,0 | 278,0 | 54,0 | 69,0 | 28 | 16,50  |
|  | 32I080040  | 80 14M 40 - 6A   | 80  | 356,51 | 353,71 | -     | 135,0 | 314,0 | 54,0 | 69,0 | 28 | 18,50  |
|  | 32I090040  | 90 14M 40 - 6A   | 90  | 401,07 | 398,28 | -     | 135,0 | 358,0 | 54,0 | 69,0 | 28 | 20,00  |
|  | 32I112040  | 112 14M 40 - 6A  | 112   | 499,11 | 496,32 | -     | 135,0 | 456,0 | 54,0 | 69,0 | 28 | 26,70  |
|  | 32I144040  | 144 14M 40 - 6A  | 144   | 641,71 | 638,92 | -     | 135,0 | 600,0 | 54,0 | 69,0 | 28 | 35,00  |
|  | 32I168040  | 168 14M 40 - 6A  | 168   | 748,66 | 745,87 | -     | 135,0 | 706,0 | 54,0 | 69,0 | 28 | 44,20  |
|  | 32I192040  | 192 14M 40 - 6A  | 192   | 855,62 | 852,82 | -     | 135,0 | 813,0 | 54,0 | 69,0 | 28 | 52,20  |
|  | 32I216040  | 216 14M 40 - 6A *  | 216   | 962,57 | 959,76 | -     | 150,0 | 920,0 | 54,0 | 69,0 | 28 | 54,00  |

\* A richiesta - On request - Auf Anfrage - Sur demande - Bajo consulta.



## Pulegge dentate HTD® monoblocco

Monobloc HTD® timing pulleys  
 Monoblock HTD® Zahnriemenscheiben  
 Poulies dentées HTD® moyeu plein  
 Poleas dentadas HTD® macizas

### HTD® 14M 55 Passo - Pitch - Teilung - Pas - Paso 14 mm

| Materiale<br>Material<br>Werkstoff<br>Matériel<br>Material | Codice<br>Item number<br>Codierung<br>Code<br>Código | Descrizione<br>Designation<br>Bezeichnung<br>Désignation<br>Referencia | N° denti<br>No. of teeth<br>Anzahl der<br>Zähne<br>Nombre de<br>dents<br>Cantidad de<br>dientes | Dp     | De     | Df    | Dm    | Di    | F    | L    | d  | Peso<br>Weight<br>Gewicht<br>Poids<br>Peso |
|--|--|--|---|--------|--------|-------|-------|-------|------|------|----|--|
|  |  |  |   | mm     | mm     | mm    | mm    | mm    | mm   | mm   | mm | kg   |
| Ghisa<br>Cast iron<br>Grauguß<br>Fonte<br>Fundición        | 32I028055  | 28 14M 55 - 6F   | 28  | 124,78 | 122,12 | 127,0 | 100,0 | -     | 70,0 | 85,0 | 24 | 5,60                                       |
|  | 32I029055  | 29 14M 55 - 6F   | 29  | 129,23 | 126,57 | 138,0 | 100,0 | -     | 70,0 | 85,0 | 24 | 6,20                                       |
|  | 32I030055  | 30 14M 55 - 6F   | 30  | 133,69 | 130,99 | 138,0 | 100,0 | -     | 70,0 | 85,0 | 24 | 7,00                                       |
|  | 32I032055  | 32 14M 55 - 6F   | 32  | 142,60 | 139,88 | 154,0 | 100,0 | -     | 70,0 | 85,0 | 24 | 7,80                                       |
|  | 32I034055  | 34 14M 55 - 6F   | 34  | 151,52 | 148,79 | 160,0 | 100,0 | -     | 70,0 | 85,0 | 24 | 8,30                                       |
|  | 32I036055  | 36 14M 55 - 6F   | 36  | 160,43 | 157,68 | 168,0 | 100,0 | -     | 70,0 | 85,0 | 24 | 9,60                                       |
|  | 32I038055  | 38 14M 55 - 6F   | 38  | 169,34 | 166,60 | 183,0 | 120,0 | -     | 70,0 | 85,0 | 24 | 11,20                                      |
|  | 32I040055  | 40 14M 55 - 6F   | 40  | 178,25 | 175,49 | 188,0 | 120,0 | -     | 70,0 | 85,0 | 24 | 12,50                                      |
|  | 32I044055  | 44 14M 55 - 6F   | 44  | 196,08 | 193,28 | 211,0 | 120,0 | -     | 70,0 | 85,0 | 24 | 15,00                                      |
|  | 32I048055  | 48 14M 55 - 10WF   | 48  | 213,90 | 211,11 | 226,0 | 135,0 | 172,0 | 70,0 | 70,0 | 24 | 13,70                                      |
|  | 32I056055  | 56 14M 55 - 10WF   | 56  | 249,55 | 246,76 | 256,0 | 135,0 | 207,0 | 70,0 | 70,0 | 28 | 15,20                                      |
|  | 32I064055  | 64 14M 55 - 10WF   | 64  | 285,21 | 282,41 | 296,0 | 135,0 | 242,0 | 70,0 | 70,0 | 28 | 18,70                                      |
|  | 32I072055  | 72 14M 55 - 10A  | 72  | 320,86 | 318,06 | -     | 135,0 | 278,0 | 70,0 | 70,0 | 28 | 19,20                                      |
|  | 32I080055  | 80 14M 55 - 10A  | 80  | 356,51 | 353,71 | -     | 135,0 | 314,0 | 70,0 | 70,0 | 28 | 20,00                                      |
|  | 32I090055  | 90 14M 55 - 10A  | 90  | 401,07 | 398,28 | -     | 135,0 | 358,0 | 70,0 | 70,0 | 28 | 22,60                                      |
|  | 32I112055  | 112 14M 55 - 10A   | 112   | 499,11 | 496,32 | -     | 135,0 | 456,0 | 70,0 | 70,0 | 28 | 29,50                                      |
|  | 32I144055  | 144 14M 55 - 10A   | 144   | 641,71 | 638,92 | -     | 135,0 | 600,0 | 70,0 | 70,0 | 28 | 39,00                                      |
|  | 32I168055  | 168 14M 55 - 10A   | 168   | 748,66 | 745,87 | -     | 135,0 | 706,0 | 70,0 | 70,0 | 28 | 51,00                                      |
|  | 32I192055  | 192 14M 55 - 10A   | 192   | 855,62 | 852,82 | -     | 135,0 | 813,0 | 70,0 | 70,0 | 28 | 58,50                                      |
|  | 32I216055  | 216 14M 55 - 10A *   | 216   | 962,57 | 959,76 | -     | 150,0 | 920,0 | 70,0 | 70,0 | 28 | 63,00                                      |

### HTD® 14M 85 Passo - Pitch - Teilung - Pas - Paso 14 mm

| Materiale<br>Material<br>Werkstoff<br>Matériel<br>Material | Codice<br>Item number<br>Codierung<br>Code<br>Código | Descrizione<br>Designation<br>Bezeichnung<br>Désignation<br>Referencia | N° denti<br>No. of teeth<br>Anzahl der<br>Zähne<br>Nombre de<br>dents<br>Cantidad de<br>dientes | Dp     | De     | Df    | Dm    | Di    | F     | L     | d  | Peso<br>Weight<br>Gewicht<br>Poids<br>Peso |
|--|--|--|---|--------|--------|-------|-------|-------|-------|-------|----|--|
|  |  |  |   | mm     | mm     | mm    | mm    | mm    | mm    | mm    | mm | kg   |
| Ghisa<br>Cast iron<br>Grauguß<br>Fonte<br>Fundición        | 32I028085  | 28 14M 85 - 6F   | 28  | 124,78 | 122,12 | 127,0 | 100,0 | -     | 102,0 | 117,0 | 24 | 8,30                                       |
|  | 32I029085  | 29 14M 85 - 6F   | 29  | 129,23 | 126,57 | 138,0 | 100,0 | -     | 102,0 | 117,0 | 24 | 8,80                                       |
|  | 32I030085  | 30 14M 85 - 6F   | 30  | 133,69 | 130,99 | 138,0 | 100,0 | -     | 102,0 | 117,0 | 24 | 9,20                                       |
|  | 32I032085  | 32 14M 85 - 6F   | 32  | 142,60 | 139,88 | 154,0 | 100,0 | -     | 102,0 | 117,0 | 24 | 11,00                                      |
|  | 32I034085  | 34 14M 85 - 6F   | 34  | 151,52 | 148,79 | 160,0 | 100,0 | -     | 102,0 | 117,0 | 24 | 12,00                                      |
|  | 32I036085  | 36 14M 85 - 6F   | 36  | 160,43 | 157,68 | 168,0 | 100,0 | -     | 102,0 | 117,0 | 32 | 13,20                                      |
|  | 32I038085  | 38 14M 85 - 6F   | 38  | 169,34 | 166,60 | 183,0 | 120,0 | -     | 102,0 | 117,0 | 32 | 15,20                                      |
|  | 32I040085  | 40 14M 85 - 6F   | 40  | 178,25 | 175,49 | 188,0 | 135,0 | -     | 102,0 | 117,0 | 32 | 17,10                                      |
|  | 32I044085  | 44 14M 85 - 6F   | 44  | 196,08 | 193,28 | 211,0 | 135,0 | -     | 102,0 | 117,0 | 32 | 21,20                                      |
|  | 32I048085  | 48 14M 85 - 6F   | 48  | 213,90 | 211,11 | 226,0 | 150,0 | -     | 102,0 | 117,0 | 32 | 25,30                                      |
|  | 32I056085  | 56 14M 85 - 10WF   | 56  | 249,55 | 246,76 | 256,0 | 150,0 | 207,0 | 102,0 | 102,0 | 32 | 23,40                                      |
|  | 32I064085  | 64 14M 85 - 10WF   | 64  | 285,21 | 282,41 | 296,0 | 150,0 | 242,0 | 102,0 | 102,0 | 32 | 27,20                                      |
|  | 32I072085  | 72 14M 85 - 10A  | 72  | 320,86 | 318,06 | -     | 150,0 | 278,0 | 102,0 | 102,0 | 32 | 28,80                                      |
|  | 32I080085  | 80 14M 85 - 10A  | 80  | 356,51 | 353,71 | -     | 150,0 | 314,0 | 102,0 | 102,0 | 32 | 30,10                                      |
|  | 32I090085  | 90 14M 85 - 10A  | 90  | 401,07 | 398,28 | -     | 150,0 | 358,0 | 102,0 | 102,0 | 32 | 33,00                                      |
|  | 32I112085  | 112 14M 85 - 10A   | 112   | 499,11 | 496,32 | -     | 150,0 | 456,0 | 102,0 | 102,0 | 32 | 41,80                                      |
|  | 32I144085  | 144 14M 85 - 10A   | 144   | 641,71 | 638,92 | -     | 150,0 | 600,0 | 102,0 | 102,0 | 32 | 52,30                                      |
|  | 32I168085  | 168 14M 85 - 10A   | 168   | 748,66 | 745,87 | -     | 150,0 | 706,0 | 102,0 | 102,0 | 32 | 60,30                                      |
|  | 32I192085  | 192 14M 85 - 10A   | 192   | 855,62 | 852,82 | -     | 165,0 | 813,0 | 102,0 | 102,0 | 32 | 86,00                                      |
|  | 32I216085  | 216 14M 85 - 10A *   | 216   | 962,57 | 959,76 | -     | 165,0 | 920,0 | 102,0 | 102,0 | 32 | 88,00                                      |

\* A richiesta - On request - Auf Anfrage - Sur demande - Bajo consulta.



## Pulegge dentate HTD® monoblocco

Monobloc HTD® timing pulleys  
Monoblock HTD® Zahnriemenscheiben  
Poulies dentées HTD® moyeu plein  
Poleas dentadas HTD® macizas

### HTD® 14M 115 Passo - Pitch - Teilung - Pas - Paso 14 mm

| Materiale<br>Material<br>Werkstoff<br>Matériel<br>Material | Codice<br>Item number<br>Codierung<br>Code<br>Código | Descrizione<br>Designation<br>Bezeichnung<br>Désignation<br>Referencia | N° denti<br>No. of teeth<br>Anzahl der<br>Zähne<br>Nombre de<br>dents<br>Cantidad de<br>dientes | Dp     | De     | Df    | Dm    | Di    | F     | L     | d  | Peso<br>Weight<br>Gewicht<br>Poids<br>Peso |
|--|--|--|---|--------|--------|-------|-------|-------|-------|-------|----|--|
|  |  |  |   | mm     | mm     | mm    | mm    | mm    | mm    | mm    | mm | mm   |
| Ghisa<br>Cast iron<br>Grauguß<br>Fonte<br>Fundición        | 32I028115  | 28 14M 115 - 6F  | 28  | 124,78 | 122,12 | 127,0 | 100,0 | -     | 133,0 | 148,0 | 32 | 10,00                                      |
|  | 32I029115  | 29 14M 115 - 6F  | 29  | 129,23 | 126,57 | 138,0 | 100,0 | -     | 133,0 | 148,0 | 32 | 11,00                                      |
|  | 32I030115  | 30 14M 115 - 6F  | 30  | 133,69 | 130,99 | 138,0 | 100,0 | -     | 133,0 | 148,0 | 32 | 11,50                                      |
|  | 32I032115  | 32 14M 115 - 6F  | 32  | 142,60 | 139,88 | 154,0 | 100,0 | -     | 133,0 | 148,0 | 32 | 13,20                                      |
|  | 32I034115  | 34 14M 115 - 6F  | 34  | 151,52 | 148,79 | 160,0 | 100,0 | -     | 133,0 | 148,0 | 32 | 14,80                                      |
|  | 32I036115  | 36 14M 115 - 6F  | 36  | 160,43 | 157,68 | 168,0 | 120,0 | -     | 133,0 | 148,0 | 32 | 16,60                                      |
|  | 32I038115  | 38 14M 115 - 6F  | 38  | 169,34 | 166,60 | 183,0 | 120,0 | -     | 133,0 | 148,0 | 32 | 19,50                                      |
|  | 32I040115  | 40 14M 115 - 6F  | 40  | 178,25 | 175,49 | 188,0 | 135,0 | -     | 133,0 | 148,0 | 32 | 22,10                                      |
|  | 32I044115  | 44 14M 115 - 6F  | 44  | 196,08 | 193,28 | 211,0 | 140,0 | -     | 133,0 | 148,0 | 32 | 27,00                                      |
|  | 32I048115  | 48 14M 115 - 6F  | 48  | 213,90 | 211,11 | 226,0 | 150,0 | -     | 133,0 | 148,0 | 32 | 32,00                                      |
|  | 32I056115  | 56 14M 115 - 6F  | 56  | 249,55 | 246,76 | 256,0 | 150,0 | -     | 133,0 | 148,0 | 32 | 44,20                                      |
|  | 32I064115  | 64 14M 115 - 10WF  | 64  | 285,21 | 282,41 | 296,0 | 150,0 | 242,0 | 133,0 | 133,0 | 32 | 35,00                                      |
|  | 32I072115  | 72 14M 115 - 10A   | 72  | 320,86 | 318,06 | -     | 150,0 | 278,0 | 133,0 | 133,0 | 32 | 36,10                                      |
|  | 32I080115  | 80 14M 115 - 10A   | 80  | 356,51 | 353,71 | -     | 150,0 | 314,0 | 133,0 | 133,0 | 32 | 38,60                                      |
|  | 32I090115  | 90 14M 115 - 10A   | 90  | 401,07 | 398,28 | -     | 150,0 | 358,0 | 133,0 | 133,0 | 32 | 41,00                                      |
|  | 32I112115  | 112 14M 115 - 10A  | 112   | 499,11 | 496,32 | -     | 150,0 | 456,0 | 133,0 | 133,0 | 32 | 52,00                                      |
|  | 32I144115  | 144 14M 115 - 10A  | 144   | 641,71 | 638,92 | -     | 165,0 | 600,0 | 133,0 | 133,0 | 32 | 67,80                                      |
|  | 32I168115  | 168 14M 115 - 10A  | 168   | 748,66 | 745,87 | -     | 165,0 | 706,0 | 133,0 | 133,0 | 32 | 84,00                                      |
|  | 32I192115  | 192 14M 115 - 10A  | 192   | 855,62 | 852,82 | -     | 165,0 | 813,0 | 133,0 | 133,0 | 32 | 101,00                                     |
|  | 32I216115  | 216 14M 115 - 10A *  | 216   | 962,57 | 959,76 | -     | 165,0 | 920,0 | 133,0 | 133,0 | 32 | 112,00                                     |

### HTD® 14M 170 Passo - Pitch - Teilung - Pas - Paso 14 mm

| Materiale<br>Material<br>Werkstoff<br>Matériel<br>Material | Codice<br>Item number<br>Codierung<br>Code<br>Código | Descrizione<br>Designation<br>Bezeichnung<br>Désignation<br>Referencia | N° denti<br>No. of teeth<br>Anzahl der<br>Zähne<br>Nombre de<br>dents<br>Cantidad de<br>dientes | Dp     | De     | Df    | Dm    | Di    | F     | L     | d  | Peso<br>Weight<br>Gewicht<br>Poids<br>Peso |
|--|--|--|---|--------|--------|-------|-------|-------|-------|-------|----|--|
|  |  |  |   | mm     | mm     | mm    | mm    | mm    | mm    | mm    | mm | mm   |
| Ghisa<br>Cast iron<br>Grauguß<br>Fonte<br>Fundición        | 32I028170  | 28 14M 170 - 6F  | 28  | 124,78 | 122,12 | 127,0 | 100,0 | -     | 187,0 | 202,0 | 32 | 13,80                                      |
|  | 32I029170  | 29 14M 170 - 6F  | 29  | 129,23 | 126,57 | 138,0 | 100,0 | -     | 187,0 | 202,0 | 32 | 14,20                                      |
|  | 32I030170  | 30 14M 170 - 6F  | 30  | 133,69 | 130,99 | 138,0 | 100,0 | -     | 187,0 | 202,0 | 32 | 15,60                                      |
|  | 32I032170  | 32 14M 170 - 6F  | 32  | 142,60 | 139,88 | 154,0 | 100,0 | -     | 187,0 | 202,0 | 32 | 18,10                                      |
|  | 32I034170  | 34 14M 170 - 6F  | 34  | 151,52 | 148,79 | 160,0 | 100,0 | -     | 187,0 | 202,0 | 32 | 20,40                                      |
|  | 32I036170  | 36 14M 170 - 6F  | 36  | 160,43 | 157,68 | 168,0 | 120,0 | -     | 187,0 | 202,0 | 32 | 23,50                                      |
|  | 32I038170  | 38 14M 170 - 6F  | 38  | 169,34 | 166,60 | 183,0 | 135,0 | -     | 187,0 | 202,0 | 32 | 26,50                                      |
|  | 32I040170  | 40 14M 170 - 6F  | 40  | 178,25 | 175,49 | 188,0 | 140,0 | -     | 187,0 | 202,0 | 32 | 30,10                                      |
|  | 32I044170  | 44 14M 170 - 6F  | 44  | 196,08 | 193,28 | 211,0 | 160,0 | -     | 187,0 | 202,0 | 32 | 37,80                                      |
|  | 32I048170  | 48 14M 170 - 6F  | 48  | 213,90 | 211,11 | 226,0 | 160,0 | -     | 187,0 | 202,0 | 32 | 44,50                                      |
|  | 32I056170  | 56 14M 170 - 6F  | 56  | 249,55 | 246,76 | 256,0 | 160,0 | -     | 187,0 | 202,0 | 32 | 61,00                                      |
|  | 32I064170  | 64 14M 170 - 6F  | 64  | 285,21 | 282,41 | 296,0 | 180,0 | -     | 187,0 | 202,0 | 32 | 81,00                                      |
|  | 32I072170  | 72 14M 170 - 10W   | 72  | 320,86 | 318,06 | -     | 180,0 | 278,0 | 187,0 | 187,0 | 32 | 61,40                                      |
|  | 32I080170  | 80 14M 170 - 10W   | 80  | 356,51 | 353,71 | -     | 180,0 | 314,0 | 187,0 | 187,0 | 32 | 72,00                                      |
|  | 32I090170  | 90 14M 170 - 10A   | 90  | 401,07 | 398,28 | -     | 180,0 | 358,0 | 187,0 | 187,0 | 38 | 68,00                                      |
|  | 32I112170  | 112 14M 170 - 10A  | 112   | 499,11 | 496,32 | -     | 200,0 | 456,0 | 187,0 | 187,0 | 38 | 87,50                                      |
|  | 32I144170  | 144 14M 170 - 10A  | 144   | 641,71 | 638,92 | -     | 220,0 | 600,0 | 187,0 | 187,0 | 38 | 114,00                                     |
|  | 32I168170  | 168 14M 170 - 10A  | 168   | 748,66 | 745,87 | -     | 220,0 | 706,0 | 187,0 | 187,0 | 38 | 142,00                                     |
|  | 32I192170  | 192 14M 170 - 10A  | 192   | 855,62 | 852,82 | -     | 220,0 | 813,0 | 187,0 | 187,0 | 38 | 157,50                                     |
|  | 32I216170  | 216 14M 170 - 10A *  | 216   | 962,57 | 959,76 | -     | 220,0 | 920,0 | 187,0 | 187,0 | 38 | 173,00                                     |

\* A richiesta - On request - Auf Anfrage - Sur demande - Bajo consulta.

Si producono a richiesta pulegge HTD® 20M (passo 20 mm).

On request we supply HTD® 20M (pitch 20 mm).

Zahnscheiben HTD® 20M (teilung 20 mm) mit standard Abmessungen sind auf Anfrage lieferbar.

On livre sur demande les poulies HTD® 20M (pas 20 mm).

Podemos entregar bajo consulta las poleas HTD® 20M (paso 20 mm).

