

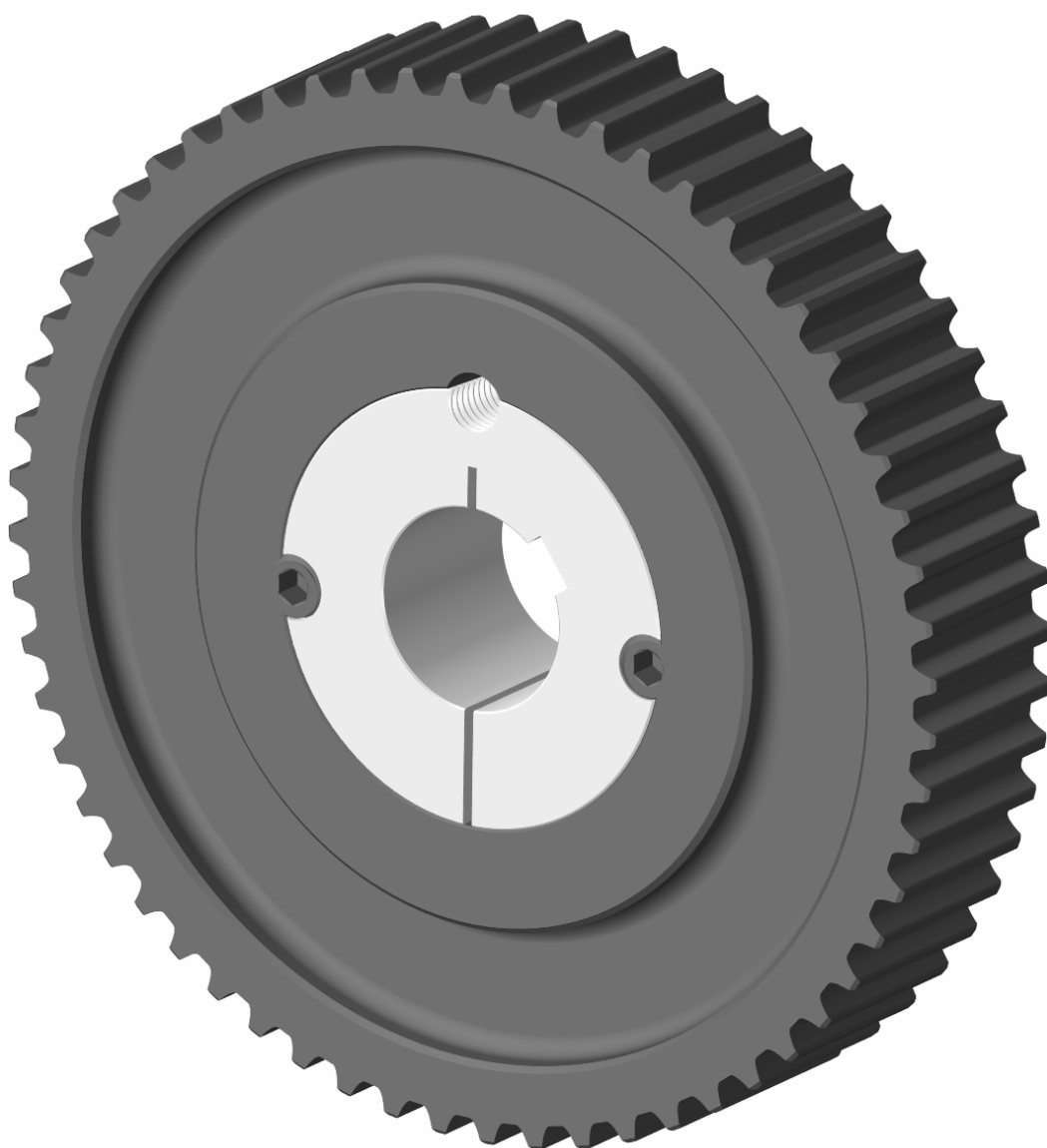

Pulegge dentate POLY CHAIN® GT

POLY CHAIN® GT timing pulleys
POLY CHAIN® GT Zahnriemenscheiben
Poulies dentées POLY CHAIN® GT
Poleas dentadas POLY CHAIN® GT





Pulegge dentate POLY CHAIN® GT

POLY CHAIN® GT timing pulleys
POLY CHAIN® GT Zahnriemenscheiben
Poulies dentées POLY CHAIN® GT
Poleas dentadas POLY CHAIN® GT

Forme costruttive

Design features - Konstruktionsmerkmale - Caractéristiques - Características

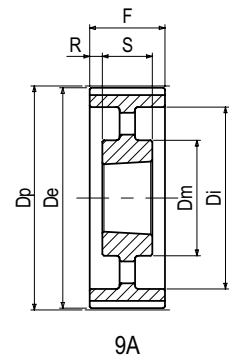
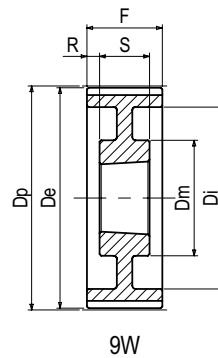
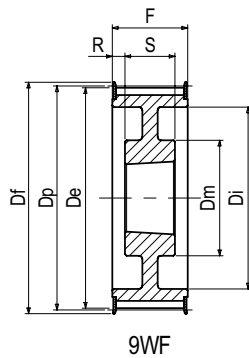
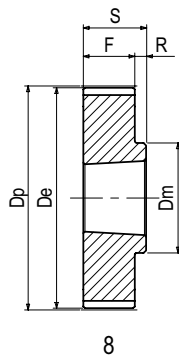
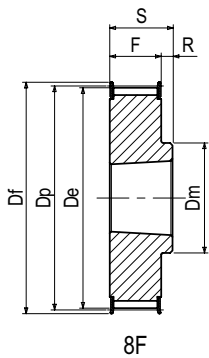
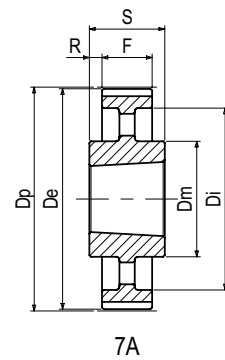
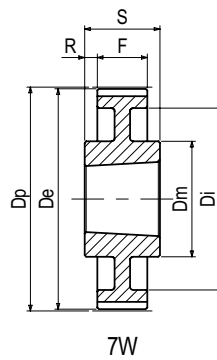
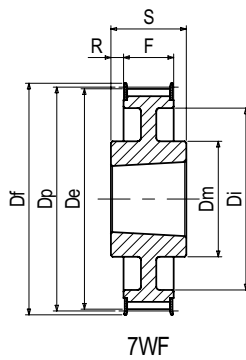
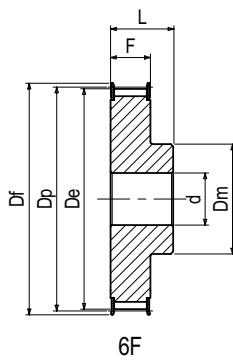
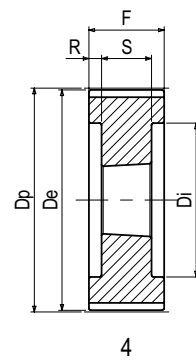
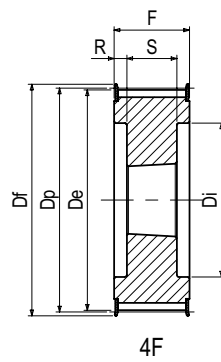
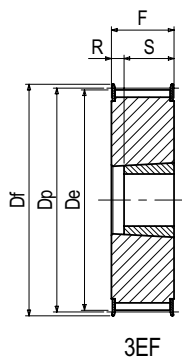
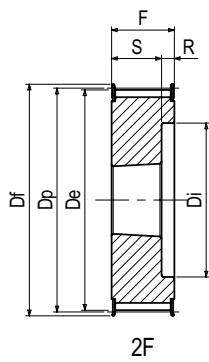



Pulegge dentate POLY CHAIN® GT

POLY CHAIN® GT timing pulleys
POLY CHAIN® GT Zahnriemenscheiben
Poulies dentées POLY CHAIN® GT
Poleas dentadas POLY CHAIN® GT

PCGT 8M 12 Passo - Pitch - Teilung - Pas - Paso 8 mm

Codice Item number Codierung Code Código	Descrizione Designation Bezeichnung Désignation Referencia	Bussola Bush Buchse Moyeu Casquillo	Foro	Dp	De	Df	Dm	Di	F	S	R	L	d	Peso Weight Gewicht Poids Peso
			Bore Bohrung Alésage Agujero max mm											
60M022012	PCGT 22 8M 12-6F	-	-	56,02	54,42	60,0	43,0	-	20,0	-	-	30,0	12	0,41
60M025012	PCGT PL 25 8M 12-8F	1108	28	63,66	62,06	70,0	48,0	-	20,0	22,0	2,00	-	-	0,30
60M028012	PCGT PL 28 8M 12-8F	1108	28	71,30	69,70	75,0	56,0	-	20,0	22,0	2,00	-	-	0,39
60M030012	PCGT PL 30 8M 12-8F	1210	32	76,39	74,79	83,0	60,0	-	20,0	25,0	5,00	-	-	0,47
60M032012	PCGT PL 32 8M 12-8F	1610	42	81,49	79,89	87,0	66,0	-	20,0	25,0	5,00	-	-	0,40
60M034012	PCGT PL 34 8M 12-8F	1610	42	86,58	84,98	91,0	69,0	-	20,0	25,0	5,00	-	-	0,51
60M036012	PCGT PL 36 8M 12-8F	1610	42	91,67	90,07	98,5	76,0	-	20,0	25,0	5,00	-	-	0,66
60M038012	PCGT PL 38 8M 12-8F	1610	42	96,77	95,17	103,0	78,0	-	20,0	25,0	5,00	-	-	0,79
60M040012	PCGT PL 40 8M 12-8F	1610	42	101,86	100,26	106,0	85,0	-	20,0	25,0	5,00	-	-	0,94
60M045012	PCGT PL 45 8M 12-8F	2012	50	114,59	112,99	119,0	92,0	-	20,0	32,0	12,00	-	-	1,24
60M048012	PCGT PL 48 8M 12-8F	2012	50	122,23	120,63	127,0	103,0	-	20,0	32,0	12,00	-	-	1,62
60M050012	PCGT PL 50 8M 12-8F	2012	50	127,32	125,72	131,0	104,0	-	20,0	32,0	12,00	-	-	1,80
60M056012	PCGT PL 56 8M 12-8F	2012	50	142,60	141,00	148,0	104,0	-	20,0	32,0	12,00	-	-	2,29
60M060012	PCGT PL 60 8M 12-8F	2012	50	152,79	151,19	158,0	111,0	-	20,0	32,0	12,00	-	-	2,75
60M064012	PCGT PL 64 8M 12-8F	2012	50	162,97	161,37	168,0	111,0	-	20,0	32,0	12,00	-	-	2,79
60M075012	PCGT PL 75 8M 12-8	2012	50	190,99	189,39	-	111,0	-	20,0	32,0	12,00	-	-	3,70
60M080012	PCGT PL 80 8M 12-8	2012	50	203,72	202,12	-	111,0	-	20,0	32,0	12,00	-	-	4,48
60M090012	PCGT PL 90 8M 12-8	2012	50	229,18	227,58	-	111,0	-	20,0	32,0	12,00	-	-	5,60

PCGT 8M 21 Passo - Pitch - Teilung - Pas - Paso 8 mm

Codice Item number Codierung Code Código	Descrizione Designation Bezeichnung Désignation Referencia	Bussola Bush Buchse Moyeu Casquillo	Foro	Dp	De	Df	Dm	Di	F	S	R	L	d	Peso Weight Gewicht Poids Peso
			Bore Bohrung Alésage Agujero max mm											
60M022021	PCGT 22 8M 21-6F	-	-	56,02	54,42	60,0	43,0	-	30,0	-	-	42,0	12	0,59
60M025021	PCGT PL 25 8M 21-3EF	1108	28	63,66	62,06	70,0	-	-	30,0	22,0	8,00	-	-	0,39
60M028021	PCGT PL 28 8M 21-3EF	1210	32	71,30	69,70	75,0	-	-	30,0	25,0	5,00	-	-	0,44
60M030021	PCGT PL 30 8M 21-3EF	1210	32	76,39	74,79	83,0	-	-	30,0	25,0	5,00	-	-	0,59
60M032021	PCGT PL 32 8M 21-3EF	1610	42	81,49	79,89	87,0	-	-	30,0	25,0	5,00	-	-	0,55
60M034021	PCGT PL 34 8M 21-3EF	1610	42	86,58	84,98	91,0	-	-	30,0	25,0	5,00	-	-	0,69
60M036021	PCGT PL 36 8M 21-3EF	1610	42	91,67	90,07	98,5	-	-	30,0	25,0	5,00	-	-	0,85
60M038021	PCGT PL 38 8M 21-3EF	1610	42	96,77	95,17	103,0	-	-	30,0	25,0	5,00	-	-	1,02
60M040021	PCGT PL 40 8M 21-3EF	1610	42	101,86	100,26	106,0	-	-	30,0	25,0	5,00	-	-	1,21
60M045021	PCGT PL 45 8M 21-8F	2012	50	114,59	112,99	120,0	92,0	-	30,0	32,0	2,00	-	-	1,45
60M048021	PCGT PL 48 8M 21-8F	2012	50	122,23	120,63	127,0	103,0	-	30,0	32,0	2,00	-	-	1,79
60M050021	PCGT PL 50 8M 21-8F	2012	50	127,32	125,72	131,0	104,0	-	30,0	32,0	2,00	-	-	2,05
60M056021	PCGT PL 56 8M 21-8F	2012	50	142,60	141,00	148,0	111,0	-	30,0	32,0	2,00	-	-	2,72
60M060021	PCGT PL 60 8M 21-8F	2517	60	152,79	151,19	158,0	124,0	-	30,0	45,0	15,00	-	-	3,58
60M064021	PCGT PL 64 8M 21-8F	2517	60	162,97	161,37	168,0	124,0	-	30,0	45,0	15,00	-	-	3,80
60M075021	PCGT PL 75 8M 21-8	2517	60	190,99	189,39	-	124,0	-	30,0	45,0	15,00	-	-	5,30
60M080021	PCGT PL 80 8M 21-8	2517	60	203,72	202,12	-	124,0	-	30,0	45,0	15,00	-	-	6,20
60M090021	PCGT PL 90 8M 21-7W	2517	60	229,18	227,58	-	124,0	198,0	30,0	45,0	7,50	-	-	5,60
60M112021	PCGT PL 112 8M 21-7W	2517	60	285,21	283,61	-	124,0	253,0	30,0	45,0	7,50	-	-	7,40
60M140021	PCGT PL 140 8M 21-7W *	3020	75	356,51	354,91	-	150,0	324,0	30,0	51,0	10,50	-	-	9,00

* A richiesta.

* On request.

* Auf Anfrage.

* Sur demande.

* Bajo consulta.

Materiali: Le pulegge dentate standard serie POLY CHAIN® GT, per esigenze costruttive, possono essere fornite in ghisa o in acciaio. La POGGI® trasmissioni meccaniche s.p.a. si riserva il diritto di fornire pulegge di entrambi i materiali.

Materials: Due to manufacture requirements, the POLY CHAIN® GT standard timing pulleys can be supplied in steel or cast-iron. POGGI® reserves the right to supply pulleys of either material.

Materialien: Wegen der Herstellungsanforderungen, können die POLY CHAIN® GT Standard Zahnscheiben im Stahl oder Grauguss geliefert werden. POGGI® behält das Recht vor, die Zahnscheiben in einem von beiden Materialien zu liefern.

Matériaux: Les poulies dentées standard POLY CHAIN® GT, à cause d'exigences de fabrication, peuvent être livrées en fonte ou en acier. La société POGGI® se réserve le droit de livrer les poulies des deux matériaux.

Materiales: Las poleas dentadas estándar POLY CHAIN® GT, debido a exigencias de fabricación, pueden entregarse en fundición o en acero. La empresa POGGI® se reserva el derecho de entregar poleas de ambos materiales.



Pulegge dentate POLY CHAIN® GT

POLY CHAIN® GT timing pulleys
POLY CHAIN® GT Zahnriemenscheiben
Poulies dentées POLY CHAIN® GT
Poleas dentadas POLY CHAIN® GT

PCGT 8M 36 Passo - Pitch - Teilung - Pas - Paso 8 mm

Codice Item number Codierung Code Código	Descrizione Designation Bezeichnung Désignation Referencia	Bussola Bush Buchse Moyeu Casquillo	Foro Bore Bohrung Alésage Agujero max mm	Dp mm	De mm	Df mm	Dm mm	Di mm	F mm	S mm	R mm	L mm	d mm	Peso Weight Gewicht Poids Peso kg
60M025036	PCGT 25 8M 36-6F	-	-	63,66	62,06	70,0	48,0	-	45,0	-	-	55,0	12	1,05
60M028036	PCGT PL 28 8M 36-3EF	1210	32	71,30	69,70	75,0	-	-	45,0	25,0	20,00	-	-	0,67
60M030036	PCGT PL 30 8M 36-3EF	1610	42	76,39	74,79	83,0	-	-	45,0	25,0	20,00	-	-	0,62
60M032036	PCGT PL 32 8M 36-3EF	1610	42	81,49	79,89	87,0	-	-	45,0	25,0	20,00	-	-	0,83
60M034036	PCGT PL 34 8M 36-3EF	1610	42	86,58	84,98	91,0	-	-	45,0	25,0	20,00	-	-	1,00
60M036036	PCGT PL 36 8M 36-3EF	1610	42	91,67	90,07	98,5	-	-	45,0	25,0	20,00	-	-	1,28
60M038036	PCGT PL 38 8M 36-3EF	1610	42	96,77	95,17	103,0	-	-	45,0	25,0	20,00	-	-	1,55
60M040036	PCGT PL 40 8M 36-3EF	2012	50	101,86	100,26	106,0	-	-	45,0	32,0	13,00	-	-	1,36
60M045036	PCGT PL 45 8M 36-3EF	2012	50	114,59	112,99	119,0	-	-	45,0	32,0	13,00	-	-	2,10
60M048036	PCGT PL 48 8M 36-3EF	2012	50	122,23	120,63	127,0	-	-	45,0	32,0	13,00	-	-	2,61
60M050036	PCGT PL 50 8M 36-3EF	2012	50	127,32	125,72	131,0	-	-	45,0	32,0	13,00	-	-	2,97
60M056036	PCGT PL 56 8M 36-3EF	2517	60	142,60	141,00	148,0	-	-	45,0	45,0	-	-	-	3,03
60M060036	PCGT PL 60 8M 36-3EF	2517	60	152,79	151,19	158,0	-	-	45,0	45,0	-	-	-	4,20
60M064036	PCGT PL 64 8M 36-3EF	2517	60	162,97	161,37	168,0	-	-	45,0	45,0	-	-	-	5,03
60M075036	PCGT PL 75 8M 36-8	3020	75	190,99	189,39	-	150,0	-	45,0	51,0	6,00	-	-	6,20
60M080036	PCGT PL 80 8M 36-8	3020	75	203,72	202,12	-	150,0	-	45,0	51,0	6,00	-	-	8,40
60M090036	PCGT PL 90 8M 36-7W	3020	75	229,18	227,58	-	150,0	197,0	45,0	51,0	3,00	-	-	7,80
60M112036	PCGT PL112 8M 36-7W	3020	75	285,21	283,61	-	150,0	253,0	45,0	51,0	3,00	-	-	10,40
60M140036	PCGT PL140 8M 36-7W *	3020	75	356,51	354,91	-	150,0	324,0	45,0	51,0	3,00	-	-	12,70
60M168036	PCGT PL168 8M 36-7W *	3525	90	427,81	426,21	-	198,0	396,0	45,0	65,0	10,00	-	-	21,50
60M192036	PCGT PL192 8M 36-7W *	3525	90	488,92	487,32	-	198,0	457,0	45,0	65,0	10,00	-	-	27,00

PCGT 8M 62 Passo - Pitch - Teilung - Pas - Paso 8 mm

Codice Item number Codierung Code Código	Descrizione Designation Bezeichnung Désignation Referencia	Bussola Bush Buchse Moyeu Casquillo	Foro Bore Bohrung Alésage Agujero max mm	Dp mm	De mm	Df mm	Dm mm	Di mm	F mm	S mm	R mm	L mm	d mm	Peso Weight Gewicht Poids Peso kg
60M030062	PCGT 30 8M 62-6F	-	-	76,39	74,79	83,0	63,0	-	72,0	-	-	84,0	15	2,44
60M032062	PCGT 32 8M 62-6F	-	-	81,49	79,89	87,0	68,0	-	72,0	-	-	84,0	15	2,83
60M034062	PCGT 34 8M 62-6F	-	-	86,58	84,98	91,0	69,0	-	72,0	-	-	84,0	15	3,07
60M036062	PCGT 36 8M 62-6F	-	-	91,67	90,07	98,5	76,0	-	72,0	-	-	84,0	15	2,82
60M038062	PCGT 38 8M 62-6F	-	-	96,77	95,17	103,0	78,0	-	72,0	-	-	84,0	15	4,07
60M040062	PCGT PL 40 8M 62-3EF	2012	50	101,86	100,26	106,0	-	-	72,0	32,0	40,00	-	-	2,27
60M045062	PCGT PL 45 8M 62-3EF	2012	50	114,59	112,99	119,0	-	-	72,0	32,0	40,00	-	-	3,54
60M048062	PCGT PL 48 8M 62-3EF	2517	60	122,23	120,63	127,0	-	-	72,0	45,0	27,00	-	-	3,21
60M050062	PCGT PL 50 8M 62-3EF	2517	60	127,32	125,72	131,0	-	-	72,0	45,0	27,00	-	-	3,69
60M056062	PCGT PL 56 8M 62-4F	2517	60	142,60	141,00	148,0	-	111,0	72,0	45,0	13,50	-	-	4,00
60M060062	PCGT PL 60 8M 62-4F	2517	60	152,79	151,19	158,0	-	121,0	72,0	45,0	13,50	-	-	5,27
60M064062	PCGT PL 64 8M 62-4F	2517	60	162,97	161,37	168,0	-	131,0	72,0	45,0	13,50	-	-	6,30
60M075062	PCGT PL 75 8M 62-4	3020	75	190,99	189,39	-	-	159,0	72,0	51,0	10,50	-	-	7,50
60M080062	PCGT PL 80 8M 62-4	3020	75	203,72	202,12	-	-	172,0	72,0	51,0	10,50	-	-	10,20
60M090062	PCGT PL 90 8M 62-4	3020	75	229,18	227,58	-	-	197,0	72,0	51,0	10,50	-	-	12,40
60M112062	PCGT PL112 8M 62-9W	3020	75	285,21	283,61	-	150,0	253,0	72,0	51,0	10,50	-	-	13,67
60M140062	PCGT PL140 8M 62-9W *	3525	90	356,51	354,91	-	198,0	324,0	72,0	65,0	3,50	-	-	23,00
60M168062	PCGT PL168 8M 62-9W *	3525	90	427,81	426,21	-	198,0	396,0	72,0	65,0	3,50	-	-	26,80
60M192062	PCGT PL192 8M 62-9W *	3525	90	488,92	487,32	-	198,0	457,0	72,0	65,0	3,50	-	-	34,20

* A richiesta.

* On request.

* Auf Anfrage.

* Sur demande.

* Bajo consulta.

Materiali: Le pulegge dentate standard serie POLY CHAIN® GT, per esigenze costruttive, possono essere fornite in ghisa o in acciaio. La POGGI® trasmissioni meccaniche s.p.a. si riserva il diritto di fornire pulegge di entrambi i materiali.

Materials: Due to manufacture requirements, the POLY CHAIN® GT standard timing pulleys can be supplied in steel or cast-iron. POGGI® reserves the right to supply pulleys of either material.

Materialien: Wegen der Herstellungsanforderungen, können die POLY CHAIN® GT Standard Zahnscheiben im Stahl oder Grauguss geliefert werden. POGGI® behält das Recht vor, die Zahnscheiben in einem von beiden Materialien zu liefern.

Matériaux: Les poulies dentées standard POLY CHAIN® GT, à cause d'exigences de fabrication, peuvent être livrées en fonte ou en acier. La société POGGI® se réserve le droit de livrer les poulies des deux matériaux.

Materiales: Las poleas dentadas estándar POLY CHAIN® GT, debido a exigencias de fabricación, pueden entregarse en fundición o en acero. La empresa POGGI® se reserva el derecho de entregar poleas de ambos materiales.



Pulegge dentate POLY CHAIN® GT

POLY CHAIN® GT timing pulleys
POLY CHAIN® GT Zahnriemenscheiben
Poulies dentées POLY CHAIN® GT
Poleas dentadas POLY CHAIN® GT

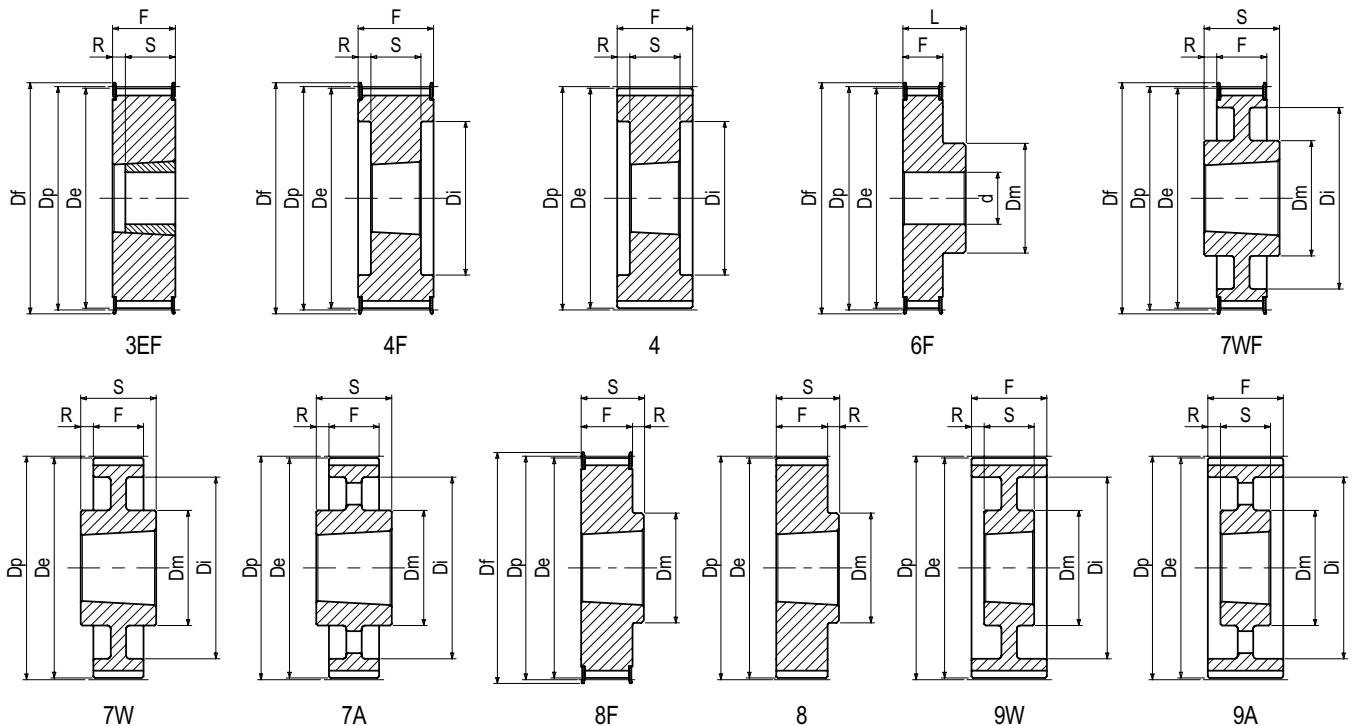

PCGT 14M 20 Passo - Pitch - Teilung - Pas - Paso 14 mm

Codice Item number Codierung Code Código	Descrizione Designation Bezeichnung Désignation Referencia	Bussola Bush Bohrung Alésage Agujero	Foro Bore Bohrung Alésage Agujero	Dp	De	Df	Dm	Di	F	S	R	L	d	Peso Weight Gewicht Poids Peso
				max mm	mm	mm	mm	mm	mm	mm	mm	mm	mm	
60P028020	PCGT PL 28 14M 20-3EF	2012	50	124,78	121,98	127,0	-	-	33,0	32,0	1,00	-	-	1,81
60P030020	PCGT PL 30 14M 20-3EF	2012	50	133,69	130,89	138,0	-	-	33,0	32,0	1,00	-	-	2,20
60P032020	PCGT PL 32 14M 20-3EF	2012	50	142,60	139,80	154,0	-	-	33,0	32,0	1,00	-	-	3,20
60P034020	PCGT PL 34 14M 20-8F	2517	60	151,52	148,72	160,0	117,0	-	33,0	45,0	12,00	-	-	3,00
60P036020	PCGT PL 36 14M 20-8F	2517	60	160,43	157,63	168,0	117,0	-	33,0	45,0	12,00	-	-	4,00
60P038020	PCGT PL 38 14M 20-8F	2517	60	169,34	166,54	183,0	117,0	-	33,0	45,0	12,00	-	-	4,00
60P040020	PCGT PL 40 14M 20-8F	2517	60	178,25	175,45	188,0	117,0	-	33,0	45,0	12,00	-	-	4,61
60P044020	PCGT PL 44 14M 20-8F	3020	75	196,08	193,28	211,0	144,0	-	33,0	51,0	18,00	-	-	6,20
60P048020	PCGT PL 48 14M 20-8F	3020	75	213,90	211,11	226,0	144,0	-	33,0	51,0	18,00	-	-	6,80
60P050020	PCGT PL 50 14M 20-8F	3020	75	222,82	220,02	230,0	144,0	-	33,0	51,0	18,00	-	-	7,80
60P056020	PCGT PL 56 14M 20-7WF	3020	75	249,55	246,76	256,0	144,0	207,0	33,0	51,0	9,00	-	-	7,80
60P060020	PCGT PL 60 14M 20-7W	3020	75	267,38	264,58	-	159,0	224,0	33,0	51,0	9,00	-	-	8,50
60P064020	PCGT PL 64 14M 20-7W	3020	75	285,21	282,41	-	159,0	242,0	33,0	51,0	9,00	-	-	10,20
60P072020	PCGT PL 72 14M 20-7W	3020	75	320,86	318,06	-	159,0	278,0	33,0	51,0	9,00	-	-	11,50
60P080020	PCGT PL 80 14M 20-7W	3020	75	356,51	353,71	-	159,0	314,0	33,0	51,0	9,00	-	-	13,50
60P090020	PCGT PL 90 14M 20-7W *	3020	75	401,07	398,27	-	159,0	360,0	33,0	51,0	9,00	-	-	14,20
60P112020	PCGT PL112 14M 20-7W *	3020	75	499,11	496,31	-	159,0	456,0	33,0	51,0	9,00	-	-	18,10
60P140020	PCGT PL140 14M 20-7W *	3020	75	623,89	621,09	-	159,0	581,0	33,0	51,0	9,00	-	-	22,90

* A richiesta.

* On request.

* Auf Anfrage.

* Sur demande.

* Bajo consulta.

Materiali: Le pulegge dentate standard serie POLY CHAIN® GT, per esigenze costruttive, possono essere fornite in ghisa o in acciaio. La POGGI® trasmissioni meccaniche s.p.a. si riserva il diritto di fornire pulegge di entrambi i materiali.

Materials: Due to manufacture requirements, the POLY CHAIN® GT standard timing pulleys can be supplied in steel or cast-iron. POGGI® reserves the right to supply pulleys of either material.

Materialien: Wegen der Herstellungsanforderungen, können die POLY CHAIN® GT Standard Zahnscheiben im Stahl oder Grauguss geliefert werden. POGGI® behält das Recht vor, die Zahnscheiben in einem von beiden Materialien zu liefern.

Matériaux: Les poulies dentées standard POLY CHAIN® GT, à cause d'exigences de fabrication, peuvent être livrées en fonte ou en acier. La société POGGI® se réserve le droit de livrer les poulies des deux matériaux.

Materialies: Las poleas dentadas estándar POLY CHAIN® GT, debido a exigencias de fabricación, pueden entregarse en fundición o en acero. La empresa POGGI® se reserva el derecho de entregar poleas de ambos materiales.



Pulegge dentate POLY CHAIN® GT

POLY CHAIN® GT timing pulleys
POLY CHAIN® GT Zahnriemenscheiben
Poulies dentées POLY CHAIN® GT
Poleas dentadas POLY CHAIN® GT

PCGT 14M 37 Passo - Pitch - Teilung - Pas - Paso 14 mm

Codice Item number Codierung Code Código	Descrizione Designation Bezeichnung Désignation Referencia	Bussola Bush Buchse Moyeu Casquillo	Foro Bore Bohrung Alésage Agujero max mm	Dp mm	De mm	Df mm	Dm mm	Di mm	F mm	S mm	R mm	L mm	d mm	Peso Weight Gewicht Poids Peso kg
60P028037	PCGT PL 28 14M 37-2F	2012	50	124,78	121,98	127,0	-	88,0	51,0	32,0	19,00	-	-	2,21
60P030037	PCGT PL 30 14M 37-4F	2517	60	133,69	130,89	138,0	-	98,0	51,0	45,0	3,00	-	-	2,68
60P032037	PCGT PL 32 14M 37-4F	2517	60	142,60	139,80	154,0	-	100,0	51,0	45,0	3,00	-	-	3,11
60P034037	PCGT PL 34 14M 37-4F	2517	60	151,52	148,72	160,0	-	109,0	51,0	45,0	3,00	-	-	3,75
60P036037	PCGT PL 36 14M 37-2F	2517	60	160,43	157,63	168,0	-	117,0	51,0	45,0	6,00	-	-	4,96
60P038037	PCGT PL 38 14M 37-2F	2517	60	169,34	166,54	183,0	-	126,0	51,0	45,0	6,00	-	-	5,20
60P040037	PCGT PL 40 14M 37-2F	2517	60	178,25	175,45	188,0	-	135,0	51,0	45,0	6,00	-	-	6,00
60P044037	PCGT PL 44 14M 37-3EF	3020	75	196,08	193,28	211,0	-	-	51,0	51,0	-	-	-	7,60
60P048037	PCGT PL 48 14M 37-3EF	3020	75	213,90	211,11	226,0	-	-	51,0	51,0	-	-	-	9,80
60P050037	PCGT PL 50 14M 37-3EF	3020	75	222,82	220,02	230,0	-	-	51,0	51,0	-	-	-	11,00
60P056037	PCGT PL 56 14M 37-9WF	3020	75	249,55	246,76	256,0	144,0	207,0	51,0	51,0	-	-	-	11,00
60P060037	PCGT PL 60 14M 37-9W	3020	75	267,38	264,58	-	159,0	224,0	51,0	51,0	-	-	-	13,00
60P064037	PCGT PL 64 14M 37-9W	3020	75	285,21	282,41	-	159,0	242,0	51,0	51,0	-	-	-	15,00
60P072037	PCGT PL 72 14M 37-9W	3020	75	320,86	318,06	-	159,0	278,0	51,0	51,0	-	-	-	13,80
60P080037	PCGT PL 80 14M 37-9W	3020	75	356,51	353,71	-	159,0	314,0	51,0	51,0	-	-	-	16,10
60P090037	PCGT PL 90 14M 37-9W *	3020	75	401,07	398,27	-	159,0	360,0	51,0	51,0	-	-	-	17,20
60P112037	PCGT PL112 14M 37-9W *	3020	75	499,11	496,31	-	159,0	456,0	51,0	51,0	-	-	-	23,00
60P140037	PCGT PL140 14M 37-7W *	3525	90	623,89	621,09	-	206,0	581,0	51,0	65,0	7,00	-	-	41,00
60P168037	PCGT PL168 14M 37-7A *	3525	90	748,66	745,87	-	206,0	706,0	51,0	65,0	7,00	-	-	51,50
60P192037	PCGT PL192 14M 37-7A *	4030	100	855,61	852,82	-	215,0	812,0	51,0	76,0	12,50	-	-	60,00

PCGT 14M 68 Passo - Pitch - Teilung - Pas - Paso 14 mm

Codice Item number Codierung Code Código	Descrizione Designation Bezeichnung Désignation Referencia	Bussola Bush Buchse Moyeu Casquillo	Foro Bore Bohrung Alésage Agujero max mm	Dp mm	De mm	Df mm	Dm mm	Di mm	F mm	S mm	R mm	L mm	d mm	Peso Weight Gewicht Poids Peso kg
60P034068	PCGT 34 14M 68-6F	-	-	151,52	148,72	160,0	122,0	-	84,0	-	-	104,0	24	11,00
60P036068	PCGT 36 14M 68-6F	-	-	160,43	157,63	168,0	129,0	-	84,0	-	-	104,0	24	12,40
60P038068	PCGT 38 14M 68-6F	-	-	169,34	166,54	183,0	139,0	-	84,0	-	-	104,0	24	13,00
60P040068	PCGT 40 14M 68-6F	-	-	178,25	175,45	188,0	152,0	-	84,0	-	-	104,0	24	15,90
60P044068	PCGT PL 44 14M 68-4F	3020	75	196,08	193,28	211,0	-	153,0	84,0	51,0	16,50	-	-	9,20
60P048068	PCGT PL 48 14M 68-2F	3020	75	213,90	211,11	226,0	-	171,0	84,0	51,0	33,00	-	-	11,30
60P050068	PCGT PL 50 14M 68-4F	3525	90	222,82	220,02	230,0	-	180,0	84,0	65,0	9,50	-	-	12,80
60P056068	PCGT PL 56 14M 68-4F	3525	90	249,55	246,76	256,0	-	207,0	84,0	65,0	9,50	-	-	17,40
60P060068	PCGT PL 60 14M 68-4	3525	90	267,38	264,58	-	-	224,0	84,0	65,0	9,50	-	-	20,60
60P064068	PCGT PL 64 14M 68-4	3525	90	285,21	282,41	-	-	242,0	84,0	65,0	9,50	-	-	24,20
60P072068	PCGT PL 72 14M 68-9W	3525	90	320,86	318,06	-	178,0	278,0	84,0	65,0	9,50	-	-	22,00
60P080068	PCGT PL 80 14M 68-9W	3525	90	356,51	353,71	-	178,0	314,0	84,0	65,0	9,50	-	-	21,60
60P090068	PCGT PL 90 14M 68-9W **	3525	90	401,07	398,27	-	178,0	360,0	84,0	65,0	9,50	-	-	35,24
60P112068	PCGT PL112 14M 68-9W *	3525	90	499,11	496,31	-	178,0	456,0	84,0	65,0	9,50	-	-	31,60
60P140068	PCGT PL140 14M 68-9W *	3525	90	623,89	621,09	-	206,0	581,0	84,0	65,0	9,50	-	-	55,00
60P168068	PCGT PL168 14M 68-9A *	3525	90	748,66	745,87	-	206,0	706,0	84,0	65,0	9,50	-	-	71,00
60P192068	PCGT PL192 14M 68-9A *	4030	100	855,61	852,82	-	215,0	812,0	84,0	76,0	4,00	-	-	80,50

* A richiesta.

** Ad esaurimento.

* On request.

** To be sold out.

* Auf Anfrage.

** Bis Ausverkauf.

* Sur demande.

** A épuiser.

* Bajo consulta.

** A agotar.

Materiali: Le pulegge dentate standard serie POLY CHAIN® GT, per esigenze costruttive, possono essere fornite in ghisa o in acciaio. La POGGI® trasmissioni meccaniche s.p.a. si riserva il diritto di fornire pulegge di entrambi i materiali.

Materials: Due to manufacture requirements, the POLY CHAIN® GT standard timing pulleys can be supplied in steel or cast-iron. POGGI® reserves the right to supply pulleys of either material.

Materialen: Wegen der Herstellungsanforderungen, können die POLY CHAIN® GT Standard Zahnriemenscheiben im Stahl oder Grauguss geliefert werden. POGGI® behält das Recht vor, die Zahnriemenscheiben in einem von beiden Materialien zu liefern.

Matériaux: Les poulies dentées standard POLY CHAIN® GT, à cause d'exigences de fabrication, peuvent être livrées en fonte ou en acier. La société POGGI® se réserve le droit de livrer les poulies des deux matériaux.

Materiales: Las poleas dentadas estándar POLY CHAIN® GT, debido a exigencias de fabricación, pueden entregarse en fundición o en acero. La empresa POGGI® se reserva el derecho de entregar poleas de ambos materiales.



Pulegge dentate POLY CHAIN® GT

POLY CHAIN® GT timing pulleys
POLY CHAIN® GT Zahnriemenscheiben
Poulies dentées POLY CHAIN® GT
Poleas dentadas POLY CHAIN® GT

PCGT 14M 90 Passo - Pitch - Teilung - Pas - Paso 14 mm

Codice Item number Codierung Code Código	Descrizione Designation Bezeichnung Désignation Referencia	Bussola Bush Buchse Moyeu Casquillo	Foro Bore Bohrung Alésage Agujero max mm	Dp mm	De mm	Df mm	Dm mm	Di mm	F mm	S mm	R mm	L mm	d mm	Peso Weight Gewicht Poids Peso kg
60P036090	PCGT 36 14M 90-6F	-	-	160,43	157,63	168,0	129,0	-	106,0	-	-	136,0	32	15,70
60P038090	PCGT 38 14M 90-6F	-	-	169,34	166,54	183,0	139,0	-	106,0	-	-	136,0	32	17,50
60P040090	PCGT 40 14M 90-6F	-	-	178,25	175,45	188,0	152,0	-	106,0	-	-	136,0	32	20,50
60P044090	PCGT 44 14M 90-6F	-	-	196,08	193,28	211,0	169,0	-	106,0	-	-	136,0	32	23,90
60P048090	PCGT PL 48 14M 90-4F	3525	90	213,90	211,11	226,0	-	171,0	106,0	65,0	20,50	-	-	12,80
60P050090	PCGT PL 50 14M 90-4F	3525	90	222,82	220,02	230,0	-	180,0	106,0	65,0	20,50	-	-	14,50
60P056090	PCGT PL 56 14M 90-4F	3525	90	249,55	246,76	256,0	-	207,0	106,0	65,0	20,50	-	-	19,10
60P060090	PCGT PL 60 14M 90-4	3525	90	267,38	264,58	-	-	224,0	106,0	65,0	20,50	-	-	22,40
60P064090	PCGT PL 64 14M 90-4	3525	90	285,21	282,41	-	-	242,0	106,0	65,0	20,50	-	-	26,50
60P072090	PCGT PL 72 14M 90-9W	3525	90	320,86	318,06	-	178,0	278,0	106,0	65,0	20,50	-	-	20,60
60P080090	PCGT PL 80 14M 90-9W	4030	100	356,51	353,71	-	215,0	314,0	106,0	76,0	15,00	-	-	27,00
60P090090	PCGT PL 90 14M 90-9W **	4030	100	401,07	398,27	-	215,0	360,0	106,0	76,0	15,00	-	-	39,80
60P112090	PCGT PL112 14M 90-9W *	4535	125	499,11	496,31	-	215,0	456,0	106,0	89,0	8,00	-	-	51,00
60P140090	PCGT PL140 14M 90-9A *	4535	125	623,89	621,09	-	215,0	581,0	106,0	89,0	8,00	-	-	61,00
60P168090	PCGT PL168 14M 90-9A *	5040	125	748,66	745,87	-	267,0	706,0	106,0	102,0	2,00	-	-	89,00
60P192090	PCGT PL192 14M 90-9A *	5040	125	855,61	852,82	-	267,0	812,0	106,0	102,0	2,00	-	-	108,50

PCGT 14M 125 Passo - Pitch - Teilung - Pas - Paso 14 mm

Codice Item number Codierung Code Código	Descrizione Designation Bezeichnung Désignation Referencia	Bussola Bush Buchse Moyeu Casquillo	Foro Bore Bohrung Alésage Agujero max mm	Dp mm	De mm	Df mm	Dm mm	Di mm	F mm	S mm	R mm	L mm	d mm	Peso Weight Gewicht Poids Peso kg
60P038125	PCGT 38 14M 125-6F	-	-	169,34	166,54	183,0	139,0	-	141,0	-	-	161,0	32	22,40
60P040125	PCGT 40 14M 125-6F	-	-	178,25	175,45	188,0	152,0	-	141,0	-	-	161,0	32	23,00
60P044125	PCGT 44 14M 125-6F	-	-	196,08	193,28	211,0	169,0	-	141,0	-	-	161,0	32	30,20
60P048125	PCGT 48 14M 125-6F	-	-	213,90	211,11	226,0	184,0	-	141,0	-	-	161,0	32	36,80
60P050125	PCGT PL 50 14M 125-4F	3525	90	222,82	220,02	230,0	-	180,0	141,0	65,0	38,00	-	-	16,80
60P056125	PCGT PL 56 14M 125-4F	3525	90	249,55	246,76	256,0	-	207,0	141,0	65,0	38,00	-	-	22,00
60P060125	PCGT PL 60 14M 125-4	4030	100	267,38	264,58	-	-	224,0	141,0	76,0	32,50	-	-	26,05
60P064125	PCGT PL 64 14M 125-4	4030	100	285,21	282,41	-	-	242,0	141,0	76,0	32,50	-	-	30,00
60P072125	PCGT PL 72 14M 125-9W	4030	100	320,86	318,06	-	215,0	278,0	141,0	76,0	32,50	-	-	30,00
60P080125	PCGT PL 80 14M 125-9W	4030	100	356,51	353,71	-	215,0	314,0	141,0	76,0	32,50	-	-	40,00
60P090125	PCGT PL 90 14M 125-9W **	4030	100	401,07	398,27	-	215,0	360,0	141,0	76,0	32,50	-	-	47,35
60P112125	PCGT PL112 14M 125-9W *	4535	125	499,11	496,31	-	215,0	456,0	141,0	89,0	26,00	-	-	56,00
60P140125	PCGT PL140 14M 125-9A *	4535	125	623,89	621,09	-	215,0	581,0	141,0	89,0	26,00	-	-	73,00
60P168125	PCGT PL168 14M 125-9A *	5040	125	748,66	745,87	-	267,0	706,0	141,0	102,0	19,50	-	-	102,00
60P192125	PCGT PL192 14M 125-9A *	5040	125	855,61	852,82	-	267,0	812,0	141,0	102,0	19,50	-	-	121,50

* A richiesta.
** Ad esaurimento.

* On request.
** To be sold out.

* Auf Anfrage.
** Bis Ausverkauf.

* Sur demande.
** A épuiser.

* Bajo consulta.
** A agotar.

Materiali: Le pulegge dentate standard serie POLY CHAIN® GT, per esigenze costruttive, possono essere fornite in ghisa o in acciaio. La POGGI® trasmissioni meccaniche s.p.a. si riserva il diritto di fornire pulegge di entrambi i materiali.

Materials: Due to manufacture requirements, the POLY CHAIN® GT standard timing pulleys can be supplied in steel or cast-iron. POGGI® reserves the right to supply pulleys of either material.

Materialien: Wegen der Herstellungsanforderungen, können die POLY CHAIN® GT Standard Zahnscheiben im Stahl oder Grauguss geliefert werden. POGGI® behält das Recht vor, die Zahnscheiben in einem von beiden Materialien zu liefern.

Matériaux: Les poulies dentées standard POLY CHAIN® GT, à cause d'exigences de fabrication, peuvent être livrées en fonte ou en acier. La société POGGI® se réserve le droit de livrer les poulies des deux matériaux.

Materiales: Las poleas dentadas estándar POLY CHAIN® GT, debido a exigencias de fabricación, pueden entregarse en fundición o en acero. La empresa POGGI® se reserva el derecho de entregar poleas de ambos materiales.

